

* LIMITING LINES FOR PAYMENT APPLY ONLY WHEN CONTRACT PROVIDES FOR UNIT PRICE PAYMENT OF PAVEMENT REPLACEMENT AND SEEDING & MULCHING.

TYP. TRENCH FOR PVC STORM & SANITARY PIPE
NOT TO SCALE

- NOTES:
- ITEM NUMBERS REFER TO STATE OF OHIO, DEPARTMENT OF TRANSPORTATION, CONSTRUCTION AND MATERIAL SPECIFICATIONS.
 - AGGREGATE FOR BEDDING IS WASHED GRAVEL NO. 57, NO. 6, NO. 67, NO. 68, OR NO. 7, ITEM 703.
 - TYPE A BACKFILL SHALL BE COMPACTED GRANULAR MATERIAL AS SPECIFIED IN ITEM 304, GRADE A. TYPE A BACKFILL SHALL BE USED WHEN THE TRENCH IS 5' OR LESS FROM ANY PAVED OR GRAVEL SURFACE, OR BENEATH THE PAVEMENT OR GRAVEL. COMPACTION SHALL MEET THE REQUIREMENTS OF ITEM 203.
 - TYPE B BACKFILL SHALL BE NATURAL SOIL FREE FROM STONES LARGER THAN 2" ACROSS THEIR GREATEST DIMENSION, TOPSOIL, VEGETATION, DEBRIS, RUBBISH, OR FROZEN MATERIAL, COMPACTED TO 95% OF ITS MAXIMUM LABORATORY DRY WEIGHT.
 - TYPE C BACKFILL SHALL BE NATURAL SOIL FREE FROM STONES LARGER THAN 6" ACROSS THEIR GREATEST DIMENSION, TOPSOIL, VEGETATION, DEBRIS, RUBBISH, OR FROZEN MATERIAL, COMPACTED TO 90% OF ITS MAXIMUM LABORATORY DRY WEIGHT. WHEN APPROVED BY THE ENGINEER, STONES NO LARGER THAN ONE CUBIC FOOT MAY BE DEPOSITED AT LEAST 3' ABOVE THE TOP OF THE PIPE.
 - THE EXCAVATED TRENCH WIDTH 12" ABOVE THE CONDUIT MAY BE INCREASED WITHOUT EXTRA COMPENSATION.
 - COVER OVER PIPE SHALL BE AS SPECIFIED ON PLANS. UNLESS OTHERWISE SPECIFIED, ROOF DRAINS SHALL HAVE 30" MIN. COVER AND SANITARY SEWER SERVICES SHALL HAVE 48" MIN. COVER.

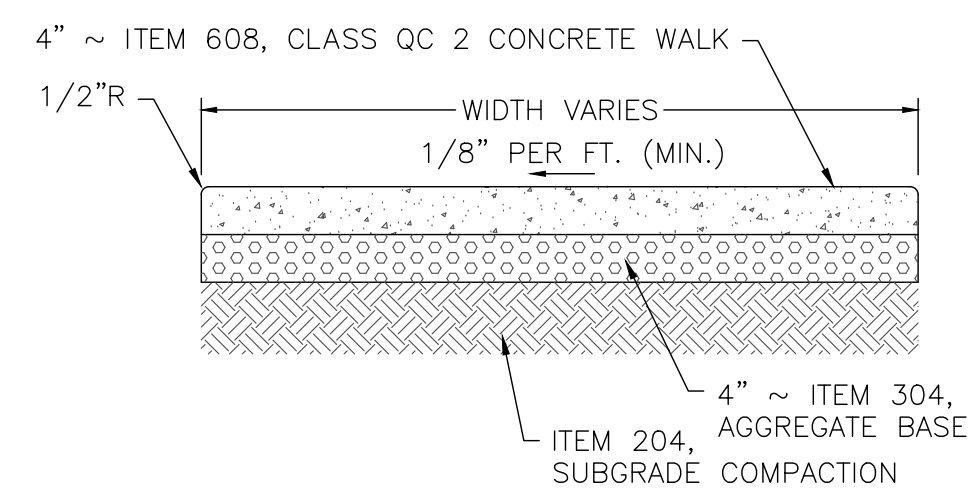

CONCRETE SIDEWALK
NOT TO SCALE

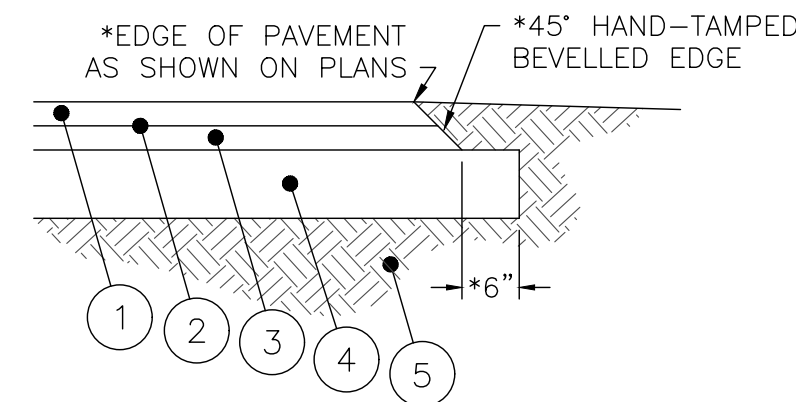

- * ONLY WHERE PAVEMENT DOES NOT ABUT CURB/SIDEWALK
- 1 1/2" ~ ITEM 441, ASPHALT CONCRETE SURFACE COURSE, TYPE 1 (448), PG64-22
 - ITEM 407, TACK COAT, 702.12, NON-TRACKING (0.10 GAL/SY) - TO BE APPLIED BETWEEN ASPHALT COURSES NOT PLACED WITHIN 24 HOURS OF EACH OTHER
 - 2" ~ ITEM 441, ASPHALT CONCRETE INTERMEDIATE COURSE, TYPE 2 (448), PG64-22
 - 8" ~ ITEM 304, AGGREGATE BASE
 - ITEM 204, SUBGRADE COMPACTION

STD. DUTY PAVEMENT
NOT TO SCALE

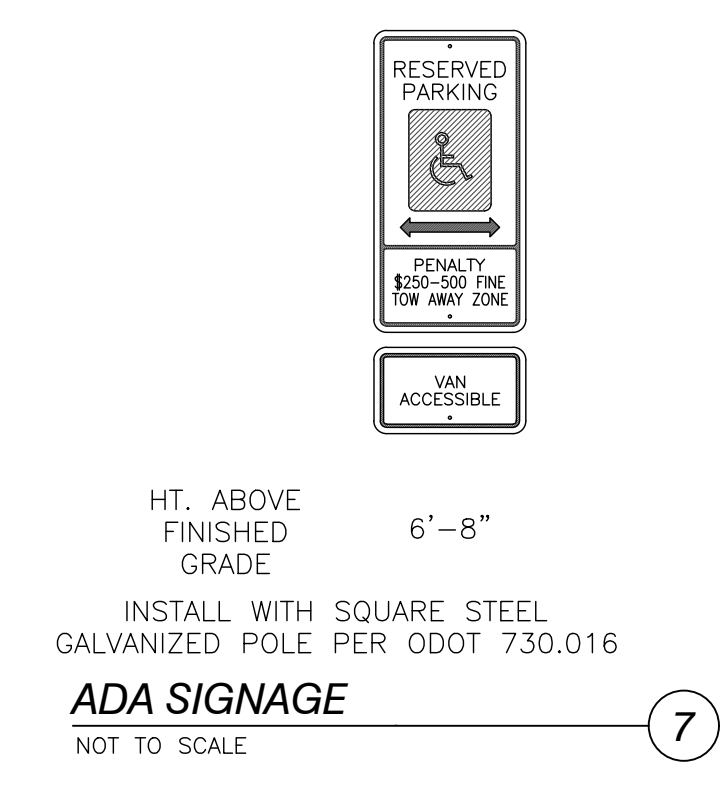

ADA SIGNAGE
NOT TO SCALE

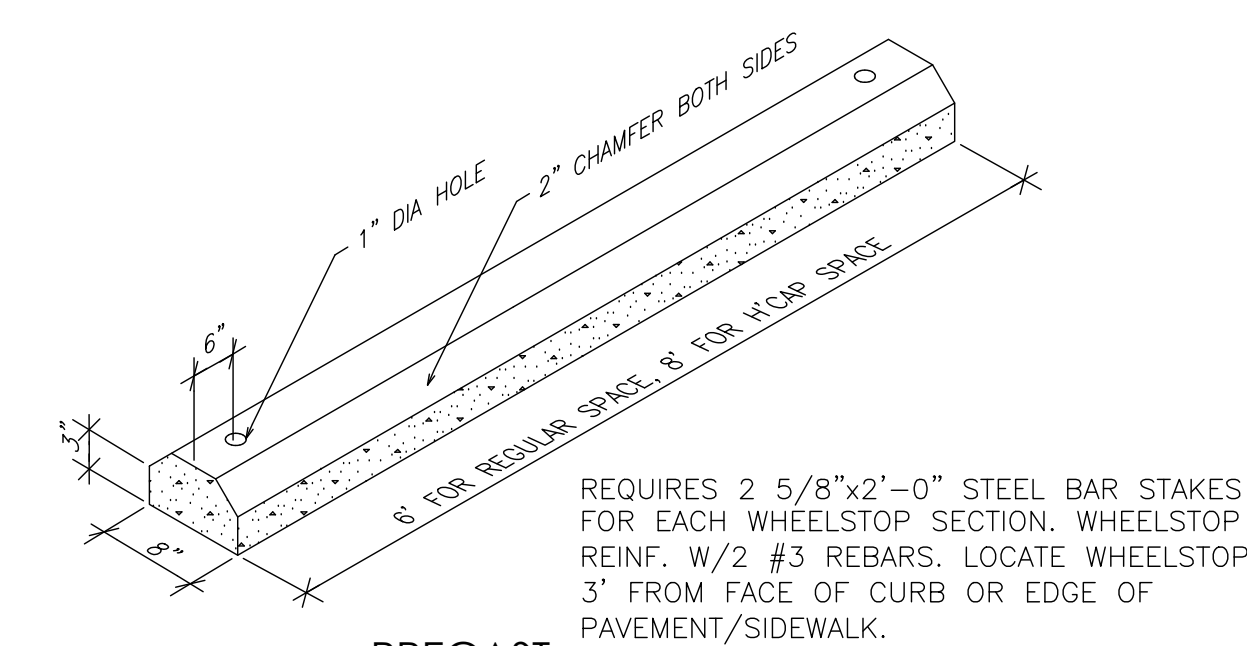

PRECAST CONCRETE WHEELSTOP
NOT TO SCALE

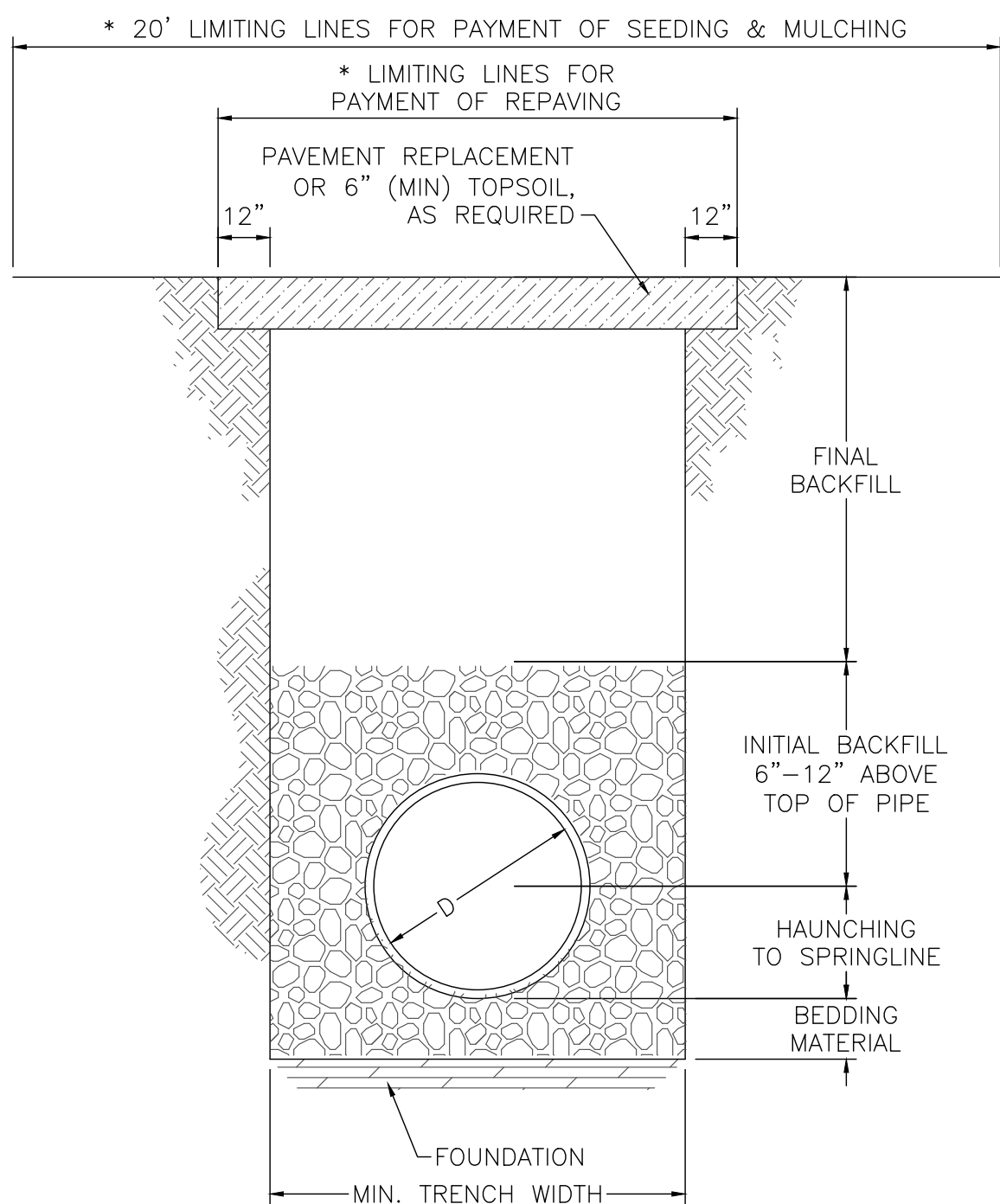

* LIMITING LINES FOR PAYMENT APPLY ONLY WHEN CONTRACT PROVIDES FOR UNIT PRICE PAYMENT OF PAVEMENT REPLACEMENT AND SEEDING & MULCHING.

TYP. TRENCH CORRUGATED PE PIPE
NOT TO SCALE

- NOTES:
- FOUNDATION: WHERE TRENCH BOTTOM IS UNSTABLE, CONTRACTOR SHALL EXCAVATE TO A DEPTH REQUIRED BY THE ENGINEER & REPLACE WITH A FOUNDATION OF CLASS I OR II MATERIAL AS DEFINED IN ASTM D2321, "STANDARD PRACTICE FOR INSTALLATION OF THERMOPLASTIC PIPE FOR SEWER & OTHER GRAVITY-FLOW APPLICATIONS", LATEST EDITION. AS AN ALTERNATIVE & AT THE DISCRETION OF THE ENGINEER, TRENCH BOTTOM MAY BE STABILIZED USING WOVEN GEOTEXTILE FABRIC.
 - BEDDING: SUITABLE MATERIAL SHALL BE CLASS I, II OR III, & INSTALLED AS REQUIRED IN ASTM D2321, LATEST EDITION.
 - UNLESS OTHERWISE SPECIFIED BY THE ENGINEER, MIN. BEDDING THICKNESS SHALL BE 4" FOR 4"-24" & 42"-48" PIPE & 6" FOR 30"-36" PIPE.
 - HAUNCHING & INITIAL BACKFILL: SUITABLE MATERIAL SHALL BE CLASS I, II OR III, & INSTALLED AS REQUIRED IN ASTM D2321, LATEST EDITION.
 - UNLESS OTHERWISE SPECIFIED BY THE ENGINEER, MIN. RECOMMENDED TRENCH WIDTHS SHALL BE AS FOLLOWS:
- | NOMINAL Ø | MIN. WIDTH |
|-----------|------------|
| 4" | 21" |
| 6" | 23" |
| 8" | 25" |
| 10" | 28" |
| 12" | 31" |
| 15" | 34" |
| 18" | 39" |
| 24" | 48" |
| 30" | 66" |
| 36" | 78" |
| 42" | 83" |
| 48" | 89" |
| 60" | 102" |
- THE EXCAVATED TRENCH WIDTH TWELVE INCHES (12") ABOVE THE CONDUIT MAY BE INCREASED WITHOUT EXTRA COMPENSATION.
- MINIMUM COVER: MIN. RECOMMENDED DEPTHS OF COVER FOR VARIOUS LIVE LOADING CONDITIONS ARE AS FOLLOWS. UNLESS OTHERWISE NOTED, ALL DIMENSIONS ARE FROM TOP OF PIPE TO GROUND SURFACE.
- | SURFACE LIVE LOADING CONDITION | MIN. COVER |
|--------------------------------|------------|
| H25 (FLEXIBLE PAVEMENT) | 12" ** |
| H25 (RIGID PAVEMENT) | 12" |
| E80 RAILWAY | 24" |
| HEAVY CONSTRUCTION | 48" |
- ** TOP OF PIPE TO BOTTOM OF BITUMINOUS PAVEMENT SECTION.

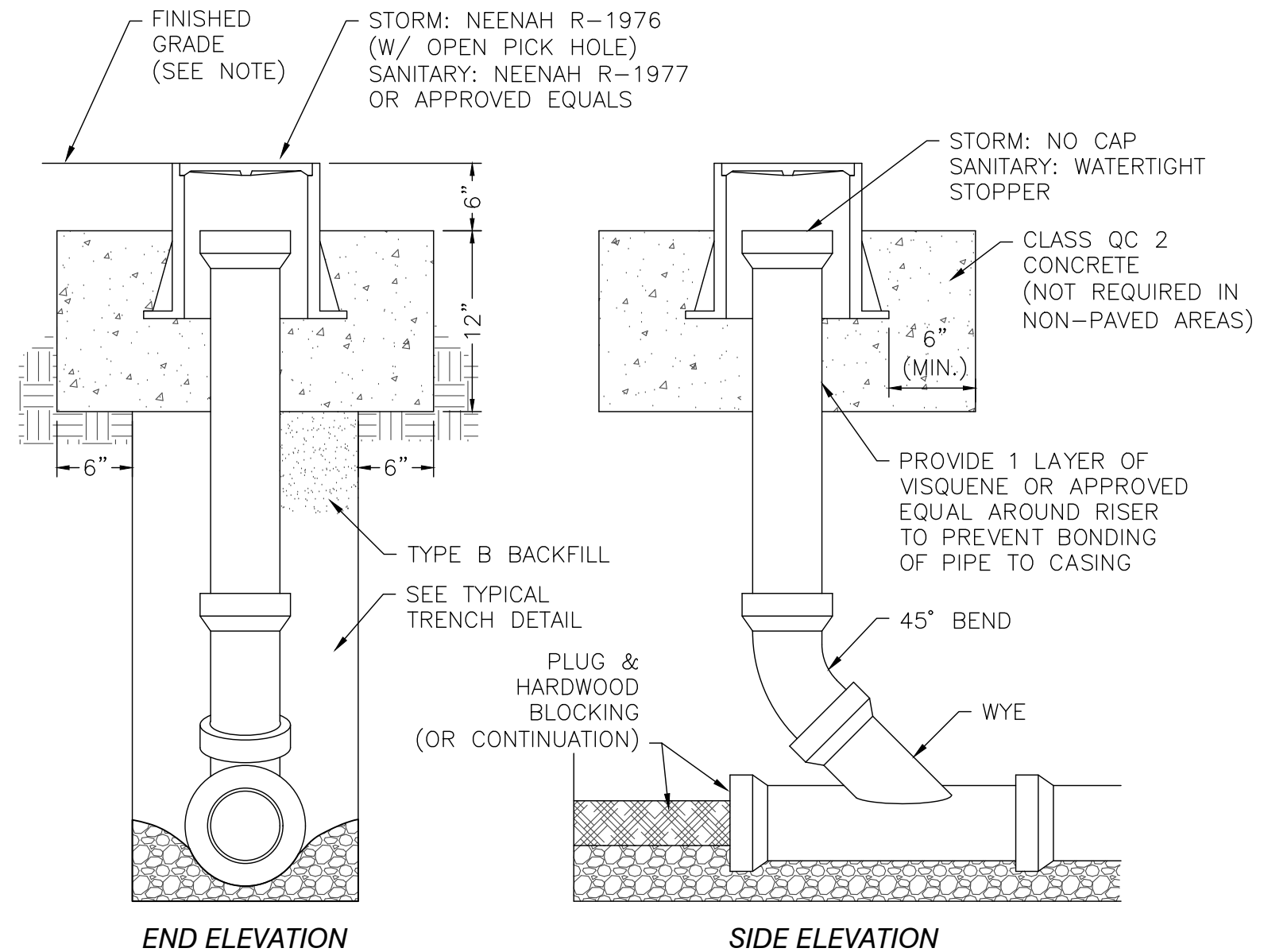

CLEANOUT
NOT TO SCALE

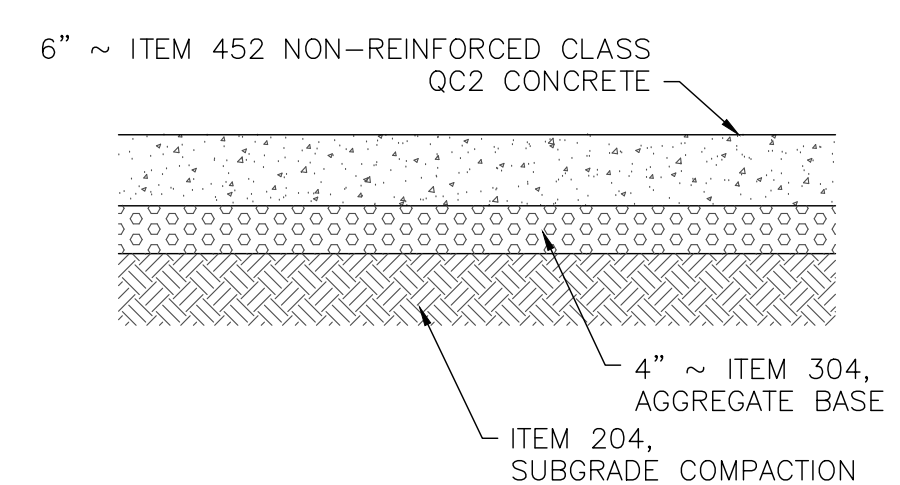

- NOTES:
- SAWCUT CONTROL JOINTS PER ODOT ITEM 451. JOINTS SHALL BE PLACED AT A MAXIMUM OF 12' APART IN EACH DIRECTION AND SHALL BE 1/2" OF THE THICKNESS OF THE CONCRETE.
 - APPLY CURING PER ODOT ITEM 451.
 - SEAL PER ODOT ITEM 512 EPOXY/URETHANE SEALER. THE 2ND COAT (URETHANE) SHALL INCLUDE 1.5 LB/SY SILICA SAND INTO THE SURFACE FOR SKID RESISTANCE.
 - ASTM D994 BITUMINOUS IMPREGNATED FIBERBOARD JOINT FILLER, 1/2" THICK, SHALL BE PLACED ADJACENT TO ALL EXISTING BUILDING WALLS AND CONCRETE SLABS.
 - PROVIDE COLD WEATHER PROTECTION PER ACI 306.1-90.

CONCRETE PAVEMENT
NOT TO SCALE

NOT FOR CONSTRUCTION

BUCKEYE HILLS CAREER CENTER
NEW TRADES BUILDING
351 BUCKEYE HILLS ROAD
RIO GRANDE, OHIO 45674

- DETAILS
- PRELIMINARY 04-21-2022
 - BID SET 03-13-2024
 - PERMIT SET
 - REVISIONS:

03-13-2024 Bid Set

C2.0



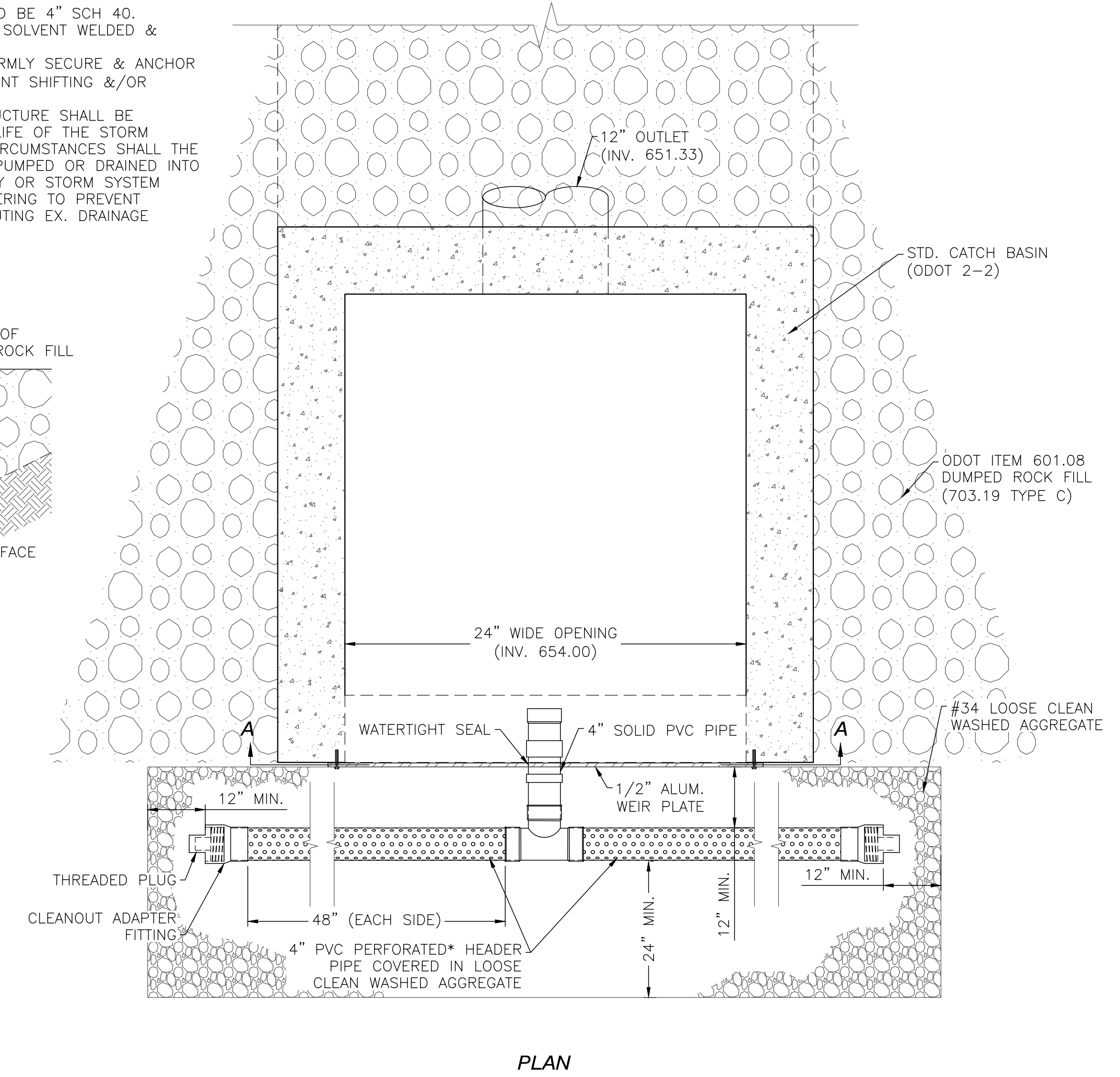
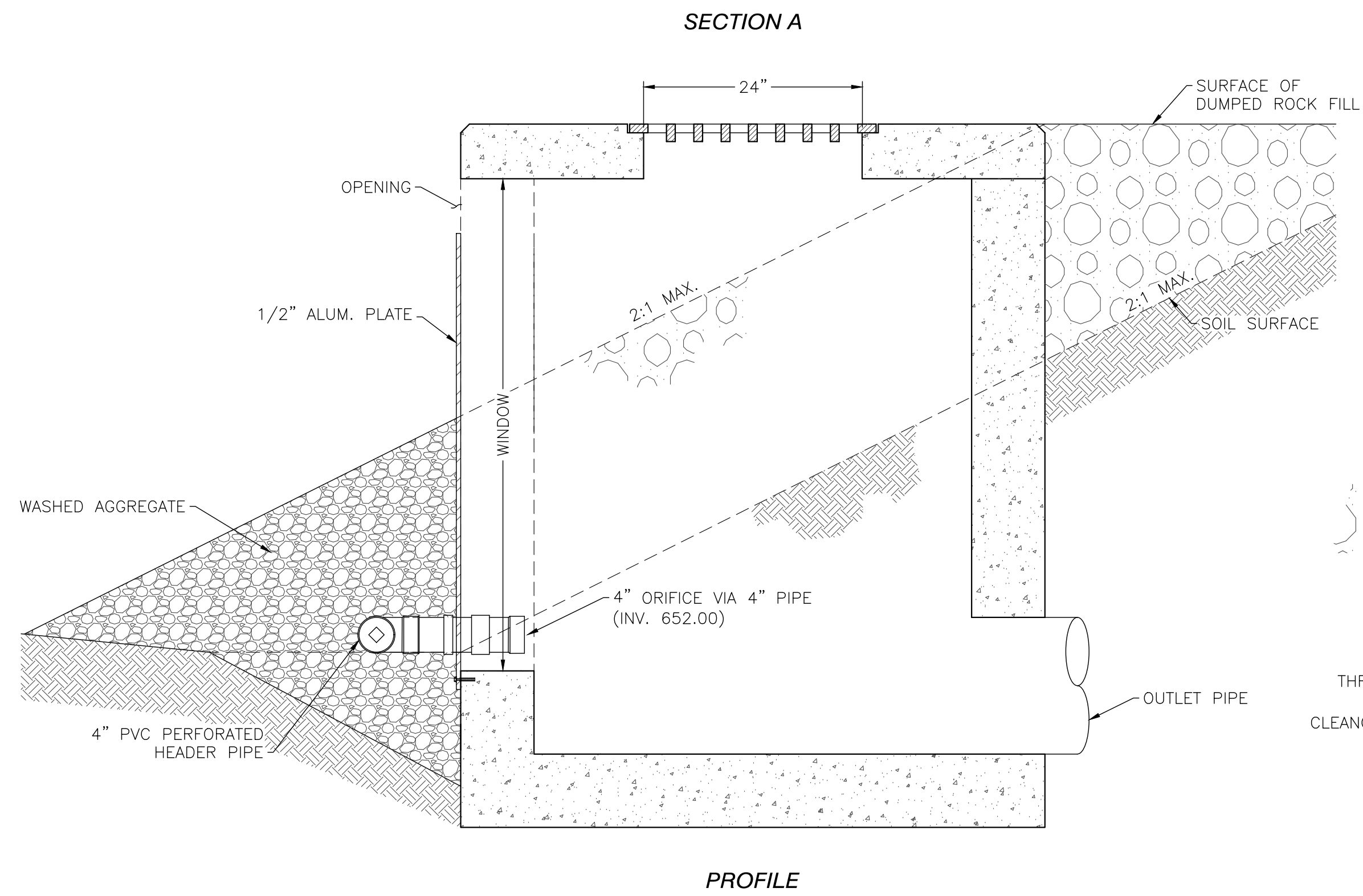
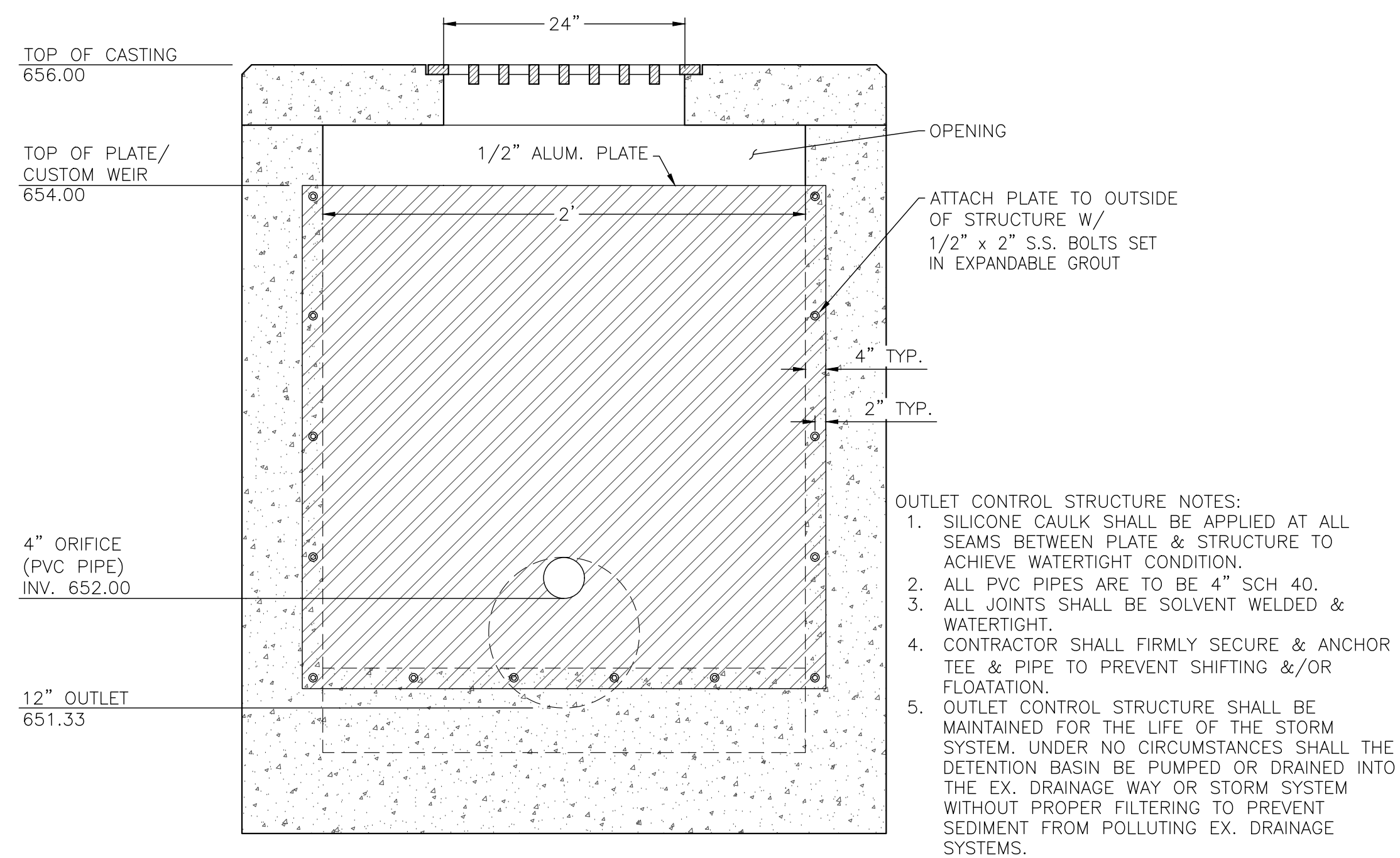
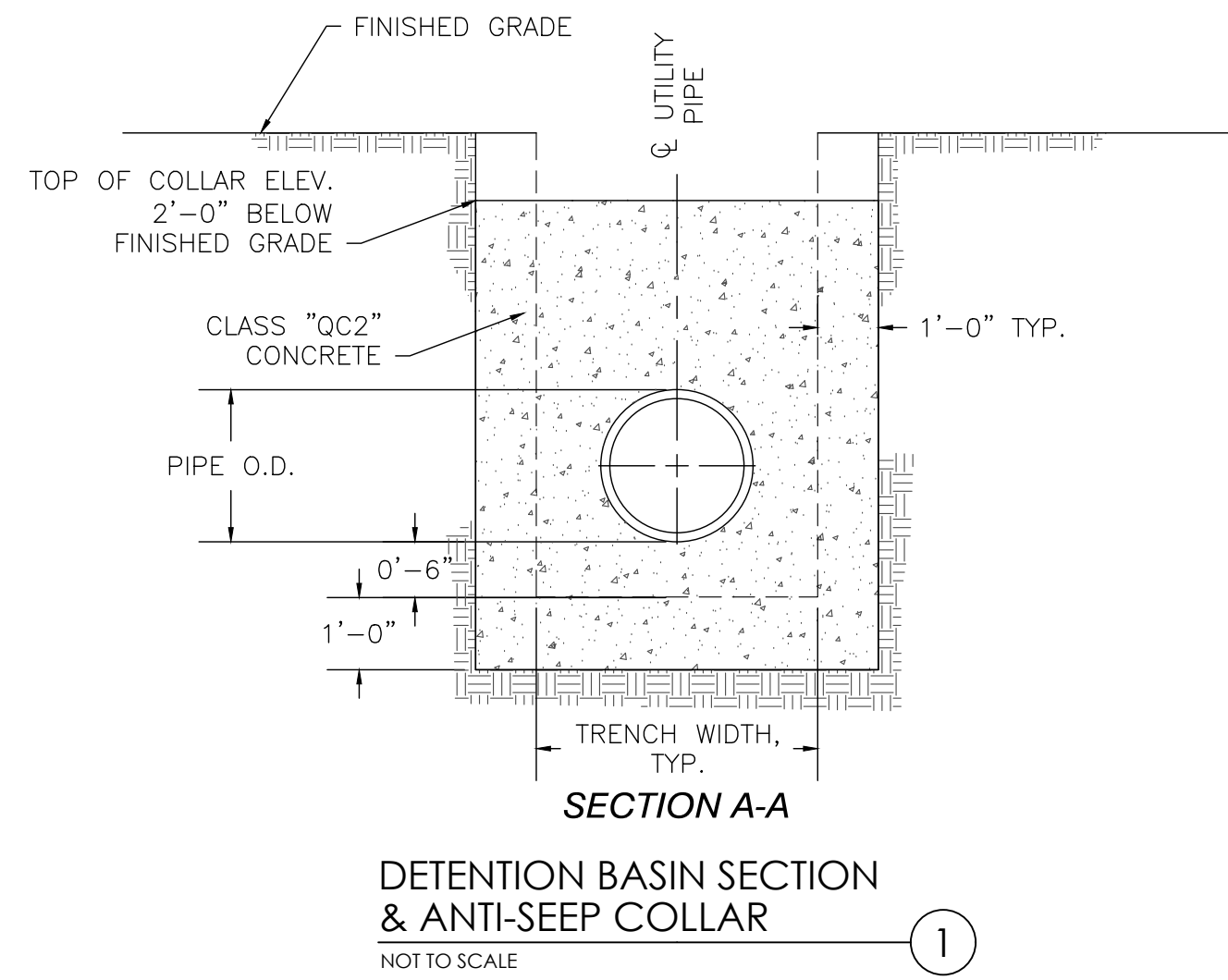
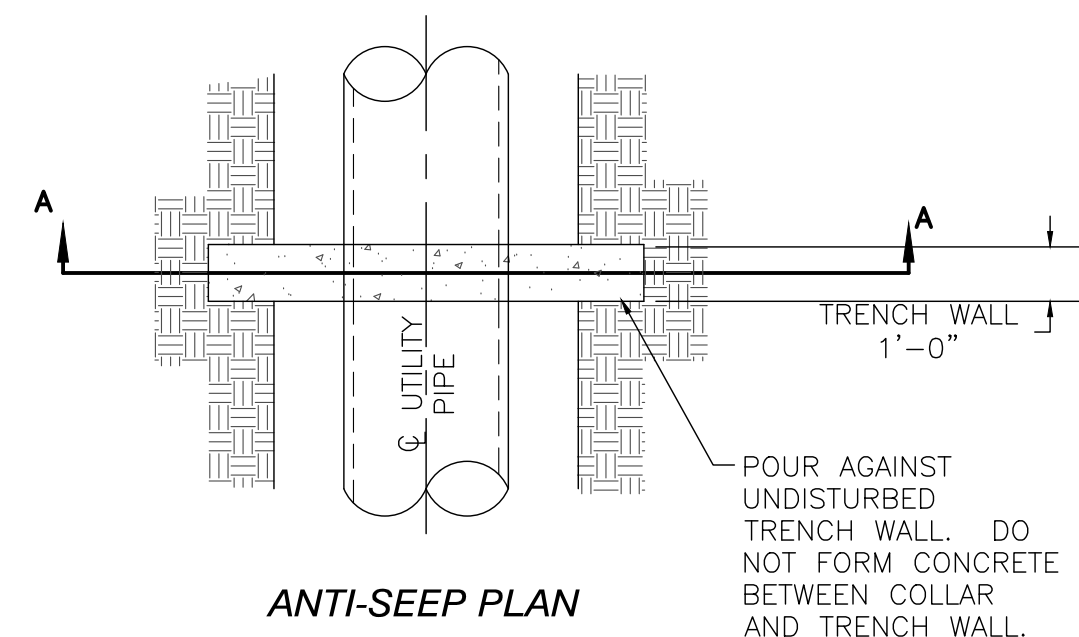
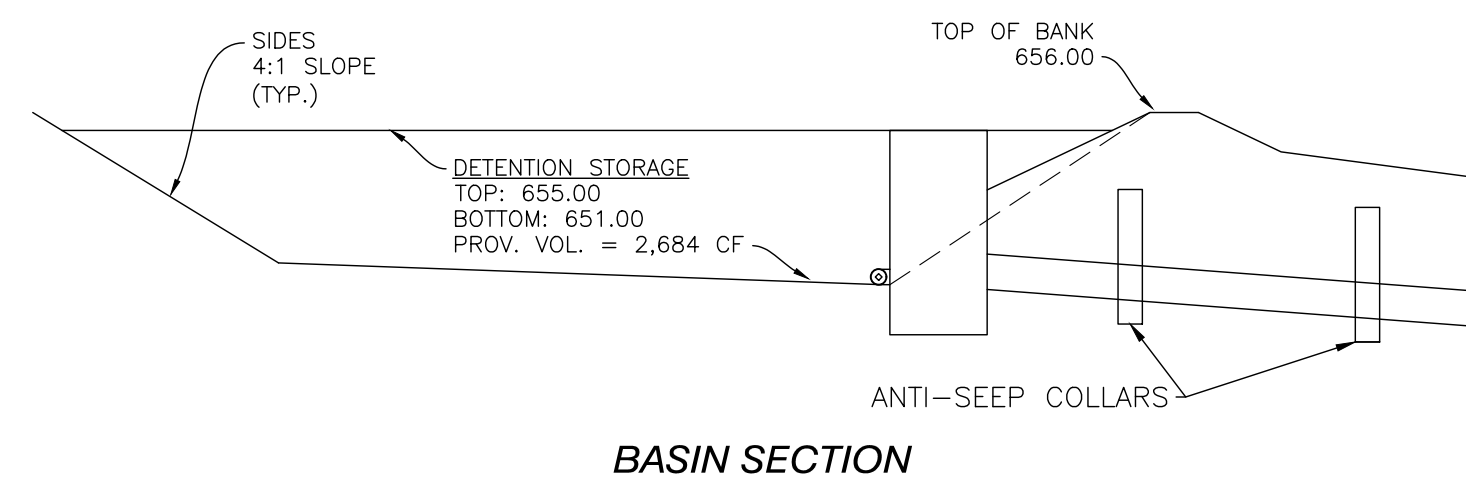

OUTLET CONTROL STRUCTURE

NOT TO SCALE

②

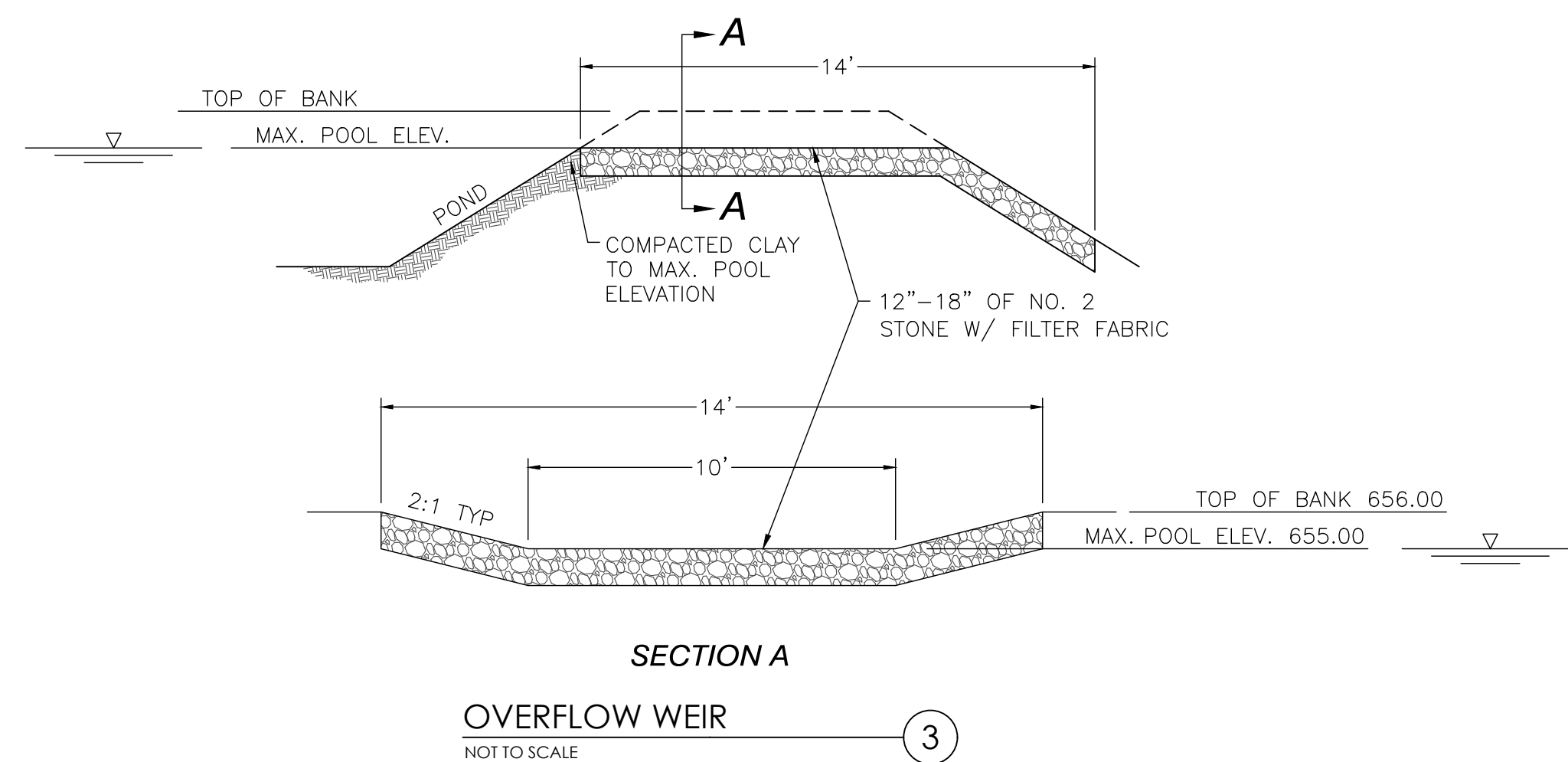

NOT FOR CONSTRUCTION

STORMWATER CONTROL DETAILS

BUCKEYE HILLS CAREER CENTER

NEW TRADES BUILDING

351 BUCKEYE HILLS ROAD
RIO GRANDE, OHIO 45674

BUCKEYE HILLS CAREER CENTER

<input type="checkbox"/> PRELIMINARY	04-21-2022
<input checked="" type="checkbox"/> BID SET	03-13-2024
<input type="checkbox"/> PERMIT SET	
<input type="checkbox"/> REVISIONS:	

03-13-2024 Bid Set

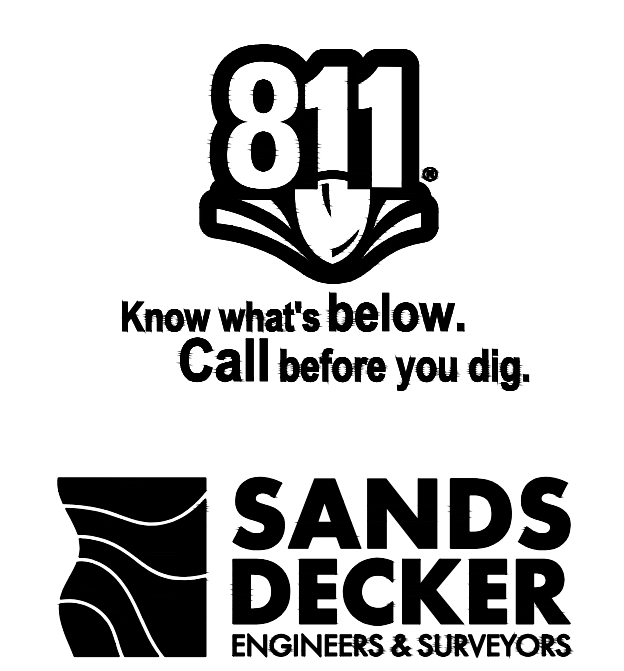

C3.0

EROSION & SEDIMENT CONTROL NOTES

OEPA NOI PERMIT #: TBD

TIMING OF SEDIMENT-TRAPPING PRACTICES:

EROSION & SEDIMENT CONTROLS SHALL COMPLY WITH OHIO EPA PERMIT NO. OH000006. ALL LAND DISTURBING ACTIVITIES SHALL BE SUBJECT TO INSPECTION & SITE INVESTIGATION BY GALLIA COUNTY AND/OR THE OHIO EPA TO DETERMINE COMPLIANCE WITH CURRENT REGULATIONS. CORRECTIVE MEASURES OR MODIFICATIONS TO ON-SITE EROSION & SEDIMENT CONTROL PRACTICES SHALL BE MADE AT THE DIRECTION OF GALLIA COUNTY OR OEPA OFFICIALS.

SEDIMENT CONTROL PRACTICES SHALL BE FUNCTIONAL THROUGHOUT EARTH-DISTURBING ACTIVITY.

PERIMETER CONTROLS & OTHER PRACTICES INTENDED TO TRAP SEDIMENT (INCLUDING THE TEMPORARY CONSTRUCTION ENTRANCE & CONCRETE WASHOUT AREA) SHALL BE IMPLEMENTED AS THE FIRST STEP OF GRADING & WITHIN SEVEN DAYS FROM THE START OF GRUBBING. THEY SHALL CONTINUE TO FUNCTION UNTIL THE UPSLOPE DEVELOPMENT AREA IS RESTABILIZED.

STABILIZATION OF DENUDED AREAS: DENUDED AREAS SHALL HAVE SOIL STABILIZATION APPLIED WITHIN SEVEN DAYS IF THEY ARE TO REMAIN DORMANT FOR MORE THAN FOURTEEN DAYS. PERMANENT OR TEMPORARY SOIL STABILIZATION SHALL BE APPLIED TO DENUDED AREAS WITHIN SEVEN DAYS AFTER FINAL GRADE IS REACHED ON ANY PORTION OF THE SITE, & SHALL ALSO BE APPLIED WITHIN SEVEN DAYS TO DENUDED AREAS WHICH MAY NOT BE AT FINAL GRADE, BUT WILL REMAIN DORMANT (UNDISTURBED) FOR LONGER THAN TWENTY-ONE DAYS.

SEDIMENT BARRIERS: SHEET FLOW RUNOFF FROM DENUDED AREAS SHALL BE FILTERED OR DIVERTED TO A SETTLING FACILITY. SEDIMENT BARRIERS SUCH AS SEDIMENT FENCE OR DIVERSIONS TO SETTLING FACILITIES SHALL PROTECT ADJACENT PROPERTIES & WATER RESOURCES FROM SEDIMENT TRANSPORTED BY SHEET FLOW.

TEMPORARY EROSION CONTROL FEATURES SHALL BE ACCEPTABLY MAINTAINED & SHALL BE REMOVED OR REPLACED WHEN DIRECTED BY THE ENGINEER AT NO COST TO THE OWNER. ALL WORK SHALL BE PERFORMED IN ACCORDANCE WITH THE SPECIFICATIONS.

ALL CONCENTRATED WATER SOURCES SHALL DISCHARGE INTO A VIABLE SEDIMENT BASIN.

ALL WATER SOURCES SHALL DISCHARGE IN A NON-EROSIVE MANNER.

ALL SOIL STOCKPILES SHALL BE PROTECTED FROM EROSION BY PERIMETER CONTROL DEVICES SUCH AS STRAW BALE DIKES OR SILT FENCES. THESE PERIMETER CONTROL DEVICES SHALL BE MAINTAINED THROUGHOUT THE LIFE OF THE PROJECT.

PERMANENT VEGETATION SHALL NOT BE CONSIDERED ESTABLISHED UNTIL GROUND COVER IS ACHIEVED WHICH, IN THE OPINION OF THE ENGINEER, PROVIDES ADEQUATE COVER & IS MATURE ENOUGH TO CONTROL SOIL EROSION SATISFACTORILY & TO SURVIVE ADVERSE WEATHER CONDITIONS.

INSPECTION SCHEDULE:

- DIVERSION SWALE & STRUCTURAL PROTECTION - INSPECT EVERY 15 DAYS OR AFTER EACH RAINSTORM PRODUCING RUNOFF, REPAIR AS REQUIRED.
- INLET PROTECTION - INSPECT FOR SEDIMENT ACCUMULATION AFTER EACH RAINFALL & DAILY DURING CONTINUED RAINFALL. REPAIR OR REPLACE WHEN WATER FLOW IS RESTRICTED BY SEDIMENT.
- VEGETATIVE PLANTING - INSPECT AFTER SPROUTING OCCURS & REPLANT BARE AREAS. INSPECT ESTABLISHED COVER EVERY 15 DAYS FOR DAMAGE. REPLANT AS REQUIRED. MAINTAIN ESTABLISHED COVER AT 6" MAX. HEIGHT. IRRIGATE AS REQUIRED DURING DRY PERIODS TO MAINTAIN LIVE VEGETATION.

CONSTRUCTION SEQUENCE:

- THE CONTRACTOR SHALL ESTABLISH A STABILIZED CONSTRUCTION ENTRANCE.
- THE CONTRACTOR SHALL PLACE THE REQUIRED TEMPORARY SEDIMENT BASINS, SEDIMENT FENCE, AND OTHER PERIMETER CONTROLS.
- THE CONTRACTOR SHALL ESTABLISH ALL SEDIMENT CONTROL STRUCTURES INCLUDING OUTLET STRUCTURES PRIOR TO DENUDED.
- THE CONTRACTOR SHALL PERFORM SITE EARTHWORK OPERATIONS IN ACCORDANCE WITH THE PLAN DETAIL AND NOTES. PROVISIONS FOR INLET PROTECTION SHALL BE ESTABLISHED AS REFERENCED BY THE DETAILS SHOWN HEREIN. THE CONTRACTOR SHALL APPLY WATER OR DUST PALLIATIVE ON DISTURBED AREAS DURING CONSTRUCTION TO ALLEVIATE OR PREVENT DUST NUISANCE. DUST PALLIATIVE SHALL CONSIST OF CALCIUM CHLORIDE. THE WATER OR CALCIUM CHLORIDE SHALL BE SPREAD UNIFORMLY OVER THE SURFACE OF THE DISTURBED AREAS.
- EXPOSED SLOPES SHALL BE STABILIZED AS SOON AS THEY ARE CONSTRUCTED.
- THE CONTRACTOR SHALL PLACE SEEDING AND MULCHING AS NECESSARY TO STABILIZE ALL DENUDED AREAS. ALL DENUDED AREAS SHALL HAVE SOIL STABILIZATION APPLIED WITHIN SEVEN (7) DAYS OF DISTURBANCE IF THEY ARE TO BE SUBSTANTIALLY UNWORKED FOR MORE THAN 14 DAYS OR IF THEY ARE AT FINAL GRADE.
- THE CONTRACTOR SHALL REMOVE AND DISPOSE OF REMAINING EROSION CONTROL DEVICES ONLY AFTER ALL AREAS HAVE ESTABLISHED VEGETATIVE COVER.
- AFTER REMOVAL OF EROSION CONTROL DEVICES, THE CONTRACTOR SHALL CLEAN ALL INLETS, STORM PIPES & DETENTION FACILITIES OF ALL SEDIMENT INCURRED DURING CONSTRUCTION.

EROSION CONTROL FABRIC: JUTE MATTING, EXCELSIOR MATTING OR A SIMILAR PRODUCT IS TO BE APPLIED ON SLOPES OF 2:1 OR GREATER. INSTALL MATTING PER MANUFACTURER AND INDUSTRY STANDARDS.

CONCRETE WASHOUT AREA: THE CONTRACTOR SHALL PROVIDE FOR AN ISOLATED CONCRETE WASHOUT AREA ONSITE. THIS LOCATION SHALL BE SHOWN ON THE CONSTRUCTION DRAWINGS OR, IF NOT SHOWN, THE LOCATION SHALL BE DETERMINED AT THE PRECONSTRUCTION CONFERENCE. NO CONCRETE DISPENSING VEHICLES SHALL BE PERMITTED TO DISCHARGE WASH WATER INTO A PRIVATE OR PUBLIC STORM SEWER SYSTEM.

ALL CONSTRUCTION AND DEMOLITION DEBRIS WASTE SHALL BE RECYCLED OR DISPOSED OF IN AN OHIO EPA APPROVED CONSTRUCTION AND DEMOLITION DEBRIS LANDFILL AS REQUIRED BY OHIO REVISED CODE 3714.

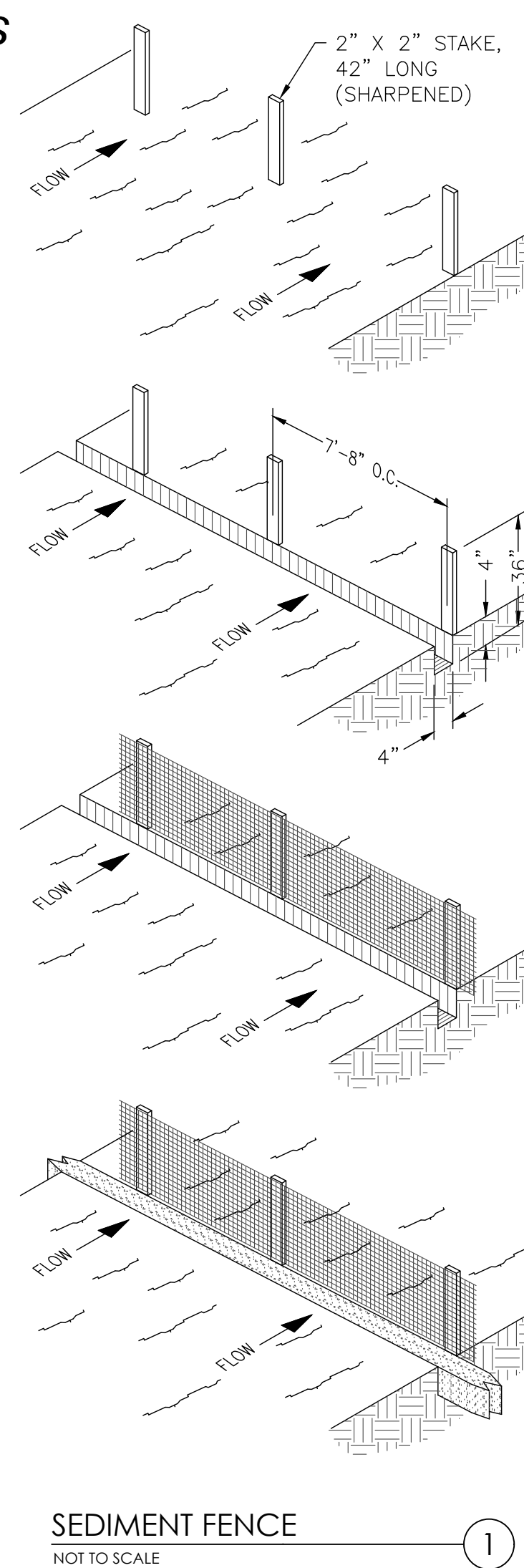

SEDIMENT FENCE
NOT TO SCALE

SILT FENCE: THIS BARRIER UTILIZES STANDARD STRENGTH OR EXTRA STRENGTH SYNTHETIC FILTER FABRIC & IS DESIGNED FOR SITUATIONS IN WHICH ONLY SHEET OR OVERLAND FLOWS ARE EXPECTED.

- HEIGHT OF BARRIER SHALL NOT EXCEED 36". HIGHER BARRIERS MAY IMPOUND VOLUMES OF WATER SUFFICIENT TO CAUSE STRUCTURE FAILURE.
- FILTER FABRIC SHALL BE FROM A CONTINUOUS ROLL & CUT TO THE LENGTH OF THE BARRIER TO AVOID THE USE OF JOINTS. WHEN JOINTS ARE NECESSARY, FABRIC SHALL BE SPLICED TOGETHER ONLY AT A SUPPORT POST, WITH A MINIMUM 6" OVERLAP, & SECURELY SEALED.
- POSTS SHALL BE SPACED AT 10' (MAX.) APART & DRIVEN SECURELY INTO THE GROUND 12" (MIN.). WHEN EXTRA STRENGTH FABRIC IS USED WITHOUT WIRE MESH SUPPORT, POST SPACING SHALL NOT EXCEED 6'.
- A TRENCH SHALL BE EXCAVATED APPROXIMATELY 4" WIDE & 4" DEEP ALONG THE LINE OF POSTS & UP-SLOPE FROM THE BARRIER.
- WHEN STANDARD STRENGTH FILTER FABRIC IS USED, A WIRE MESH SUPPORT SHALL BE FASTENED SECURELY TO THE UP-SLOPE SIDE OF THE POSTS USING HEAVY DUTY WIRE STAPLES AT LEAST 1" LONG, TIE WIRES OR HOG RINGS. WIRE MESH SHALL EXTEND INTO THE TRENCH 2" (MIN.) & SHALL NOT EXTEND MORE THAN 36" ABOVE THE ORIGINAL GROUND SURFACE.
- STANDARD STRENGTH FILTER FABRIC SHALL BE STAPLED OR WIRED TO THE MESH & 8" OF THE FABRIC SHALL BE EXTENDED INTO THE TRENCH. FABRIC SHALL NOT EXTEND MORE THAN 36" ABOVE THE ORIGINAL GROUND SURFACE. FILTER FABRIC SHALL NOT BE STAPLED TO EXISTING TREES.
- WHEN EXTRA STRENGTH FILTER FABRIC & CLOSER POST SPACING ARE USED, THE WIRE MESH SUPPORT MAY BE ELIMINATED. IN SUCH CASE, FILTER FABRIC IS STAPLED OR WIRED DIRECTLY TO POSTS WITH ALL OTHER PROVISIONS OF ITEM NO. 6 APPLYING.
- THE TRENCH SHALL BE BACKFILLED & SOIL COMPACTED OVER THE FILTER FABRIC.
- SILT FENCES SHALL BE REMOVED WHEN THEY HAVE SERVED THEIR USEFUL PURPOSE, BUT NOT BEFORE THE UP-SLOPE AREA HAS BEEN PERMANENTLY STABILIZED.

MAINTENANCE:

INSPECT IMMEDIATELY AFTER EACH RAINFALL & AT LEAST DAILY DURING PROLONGED RAINFALL. REQUIRED REPAIRS SHALL BE MADE IMMEDIATELY.

SHOULD THE FILTER FABRIC DECOMPOSE OR BECOME INEFFECTIVE WHILE THE BARRIER IS STILL NECESSARY, THE FABRIC SHALL BE REPLACED PROMPTLY.

SEDIMENT DEPOSITS SHOULD BE REMOVED AFTER EACH STORM EVENT. THEY MUST BE REMOVED WHEN DEPOSITS REACH APPROXIMATELY HALF THE HEIGHT OF THE BARRIER.

ANY SEDIMENT DEPOSITS REMAINING IN PLACE AFTER THE BARRIER IS NO LONGER REQUIRED SHALL BE DRESSED TO CONFORM TO EXISTING GRADE, PREPARED & SEEDED.

DESIGN CAPACITY CHART:

MAX. DRAINAGE AREA PER 100 LF OF BARRIER	RANGE OF SLOPE PER DRAINAGE AREA
0.5 AC.	<2%
0.25 AC.	≥2% BUT <20%
0.125 AC.	≥20% BUT <50%

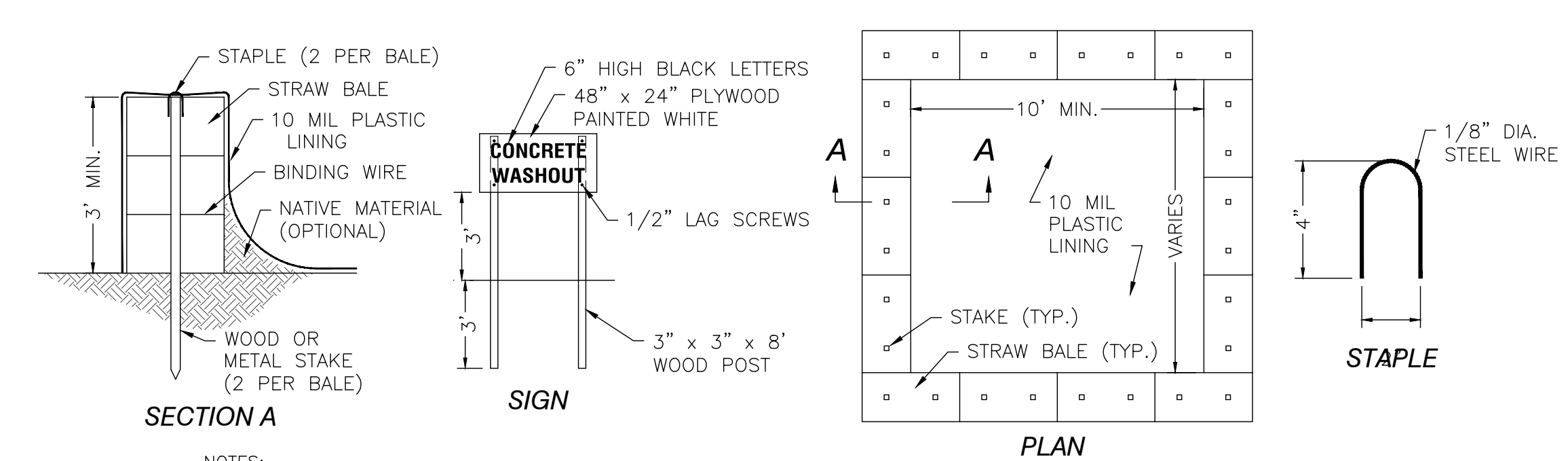

CONCRETE WASHOUT AREA
NOT TO SCALE

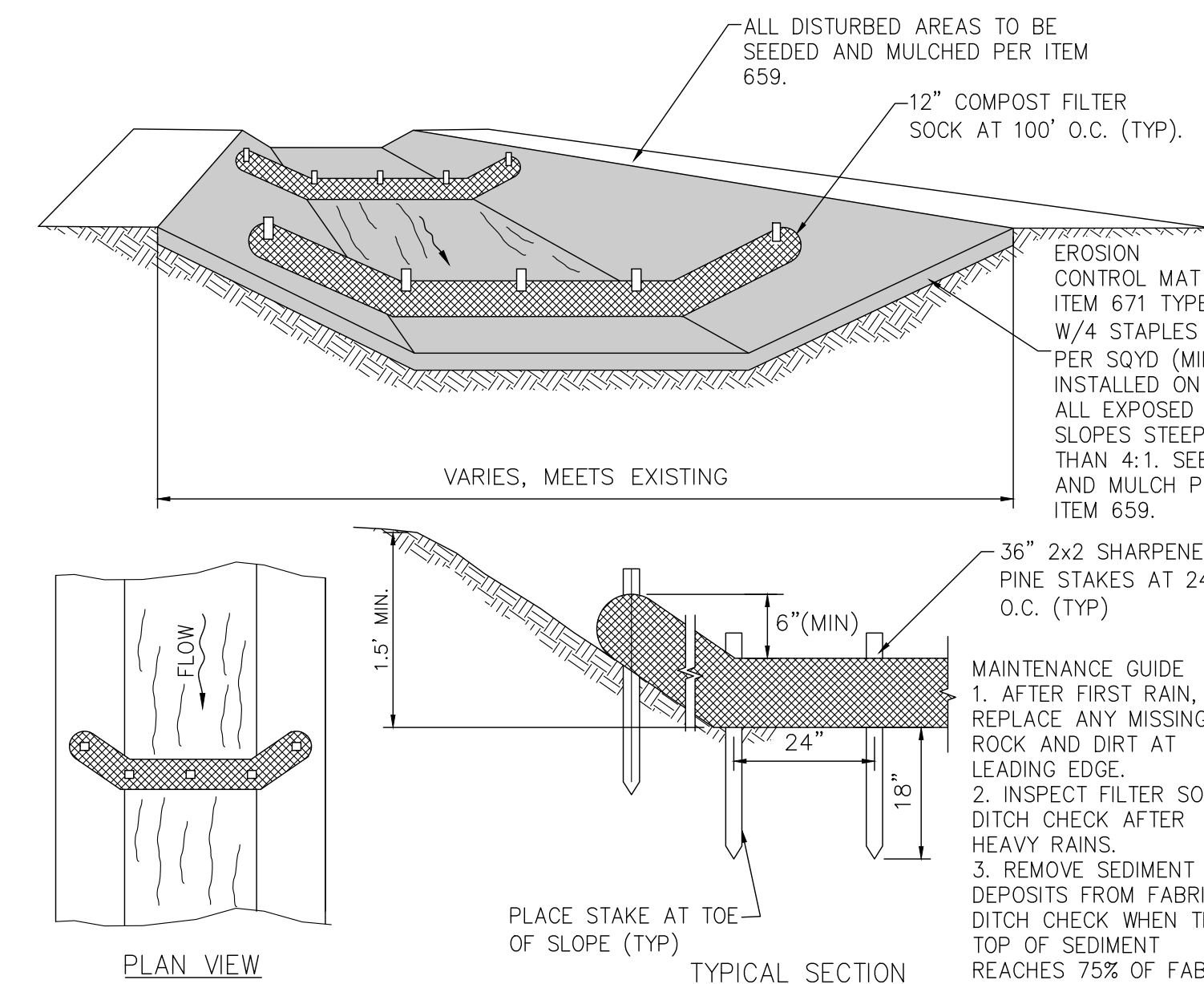

DITCH CHECK DETAIL
NOT TO SCALE

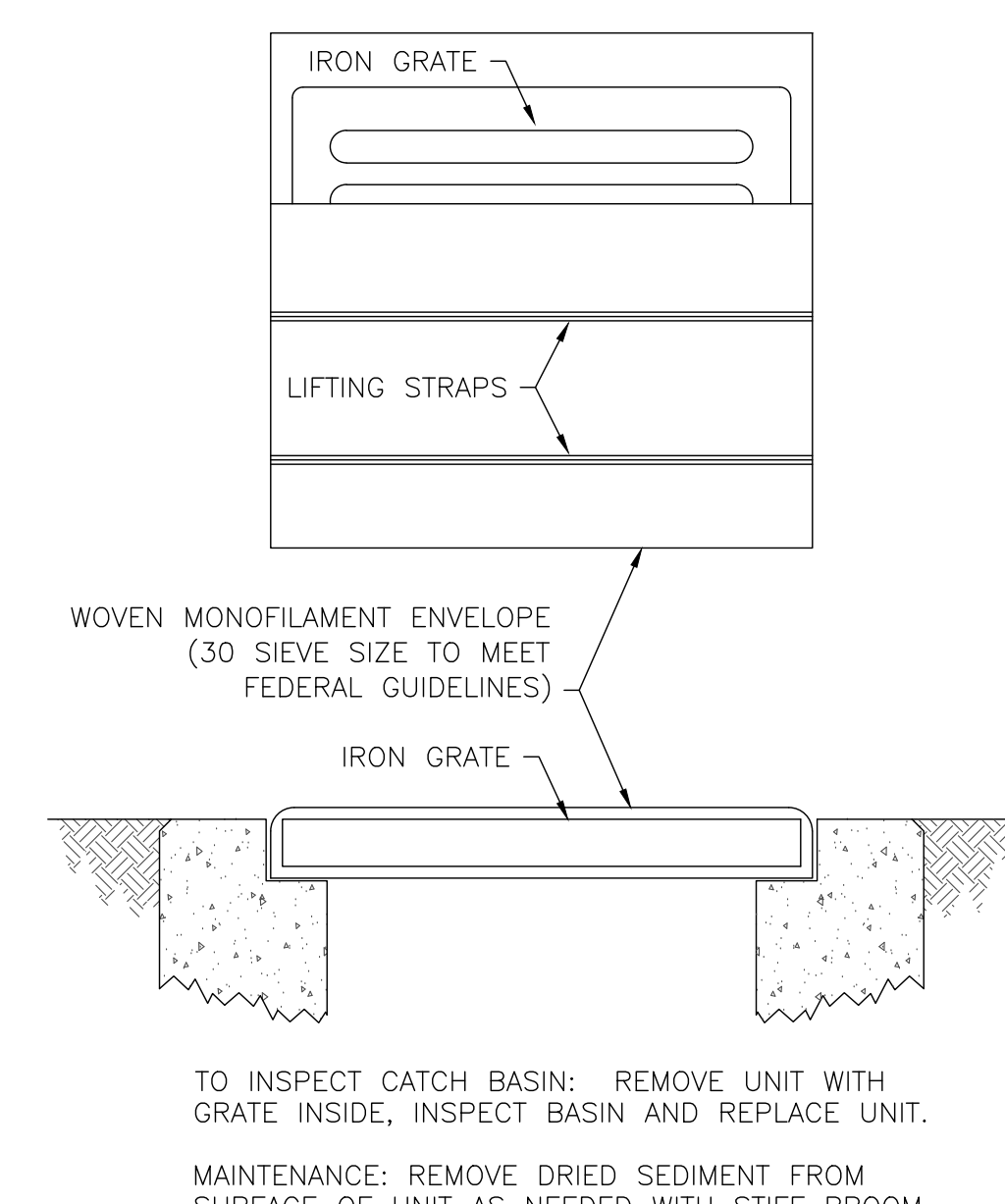

INLET PROTECTION (PAVEMENT AREAS)
NOT TO SCALE

TEMPORARY STABILIZATION	
AREAS REQUIRING STABILIZATION	TIME FRAME
• ANY DISTURBED AREAS WITHIN 50 FEET OF A SURFACE WATER OF THE STATE AND NOT AT A FINAL GRADE	WITHIN 2 DAYS OF THE MOST RECENT DISTURBANCE IF THE AREA WILL REMAIN IDLE FOR MORE THAN 14 DAYS
• FOR ALL CONSTRUCTION ACTIVITIES, ANY DISTURBED AREAS THAT WILL BE DORMANT FOR MORE THAN 14 DAYS BUT LESS THAN ONE YEAR, AND NOT WITHIN 50 FEET OF A SURFACE WATER OF THE STATE	WITHIN 7 DAYS OF THE MOST RECENT DISTURBANCE WITHIN THE AREA
• DISTURBED AREAS THAT WILL BE IDLE OVER WINTER	PRIOR TO THE ONSET OF WINTER WEATHER

PERMANENT STABILIZATION	
AREAS REQUIRING STABILIZATION	TIME FRAME
• ANY AREAS THAT WILL LIE DORMANT FOR ONE YEAR OR MORE	WITHIN 7 DAYS OF THE MOST RECENT DISTURBANCE
• ANY AREAS WITHIN 50 FEET OF A SURFACE WATER OF THE STATE AND AT FINAL GRADE	WITHIN TWO DAYS OF REACHING FINAL GRADE
• ANY OTHER AREAS AT FINAL GRADE	WITHIN 7 DAYS OF REACHING FINAL GRADE IN THAT AREA

POST-CONSTRUCTION EXTENDED DETENTION BASIN MAINTENANCE ACTIVITIES	
MAINTENANCE ACTIVITY	FREQUENCY
CONDUCT ANNUAL VEGETATION MANAGEMENT DURING THE SUMMER, REMOVING WEEDS AND HARVESTING VEGETATION. REMOVE ALL GRASS CUTTINGS AND OTHER GREEN WASTE AND DISPOSE OF PROPERLY.	ONCE A YEAR
TRIM VEGETATION AT BEGINNING AND END OF WET SEASON TO PREVENT ESTABLISHMENT OF WOODY VEGETATION, AND FOR AESTHETICS AND MOSQUITO CONTROL.	TWICE A YEAR (SPRING AND FALL)
EVALUATE HEALTH OF VEGETATION AND REMOVE AND REPLACE ANY DEAD OR DYING PLANTS. REMOVE ALL GREEN WASTE AND DISPOSE OF PROPERLY.	TWICE A YEAR
CONDUCT REGULAR MOWING AND REMOVE ALL GRASS CUTTINGS. AVOID PRODUCING RUTS WHEN MOWING.	AT LEAST WEEKLY DURING GROWING SEASON OR MORE FREQUENTLY AS NEEDED.
REMOVE ACCUMULATED SEDIMENT FROM THE SUMP IN THE OUTLET CONTROL STRUCTURE.	EVERY TWO WEEKS OR MORE FREQUENTLY AS NEEDED.
REMOVE ACCUMULATED TRASH AND DEBRIS FROM EXTENDED DETENTION BASIN AND DISPOSE OF TRASH AND DEBRIS PROPERLY.	WEEKLY
INSPECT EXTENDED DETENTION BASIN USING INSPECTION CHECKLIST	QUARTERLY OR AS NEEDED
REMOVE ANY DEBRIS OR CLOGS FROM OUTLET ORIFICES AND UNDER-DRAINS.	AS NEEDED
MOSQUITO ABATEMENT	AS NEEDED

MAINTENANCE LOG NOTES:

THE PROPERTY OWNER, ITS ADMINISTRATORS, EXECUTORS, SUCCESSORS, HEIRS OR ASSIGNS SHALL MAINTAIN THE STORMWATER CONTROL FACILITY OR FACILITIES IN GOOD WORKING CONDITION ACCEPTABLE TO THE CITY AND IN ACCORDANCE WITH THE SCHEDULE OF LONG-TERM MAINTENANCE ACTIVITIES IN THE STORMWATER CONTROL FACILITY MAINTENANCE PLAN.

SIGNED INSPECTION CHECKLISTS IN A MAINTENANCE INSPECTION LOG, ALONG WITH RECORDED DATES AND DESCRIPTIONS OF MAINTENANCE ACTIVITIES PERFORMED BY THE PROPERTY OWNER TO REMEDY THE DEFICIENCIES OBSERVED DURING PRIOR INSPECTIONS. THE MAINTENANCE INSPECTION LOG SHALL BE KEPT ON THE PROPERTY AND SHALL BE MADE AVAILABLE TO GALLIA COUNTY UPON REQUEST.

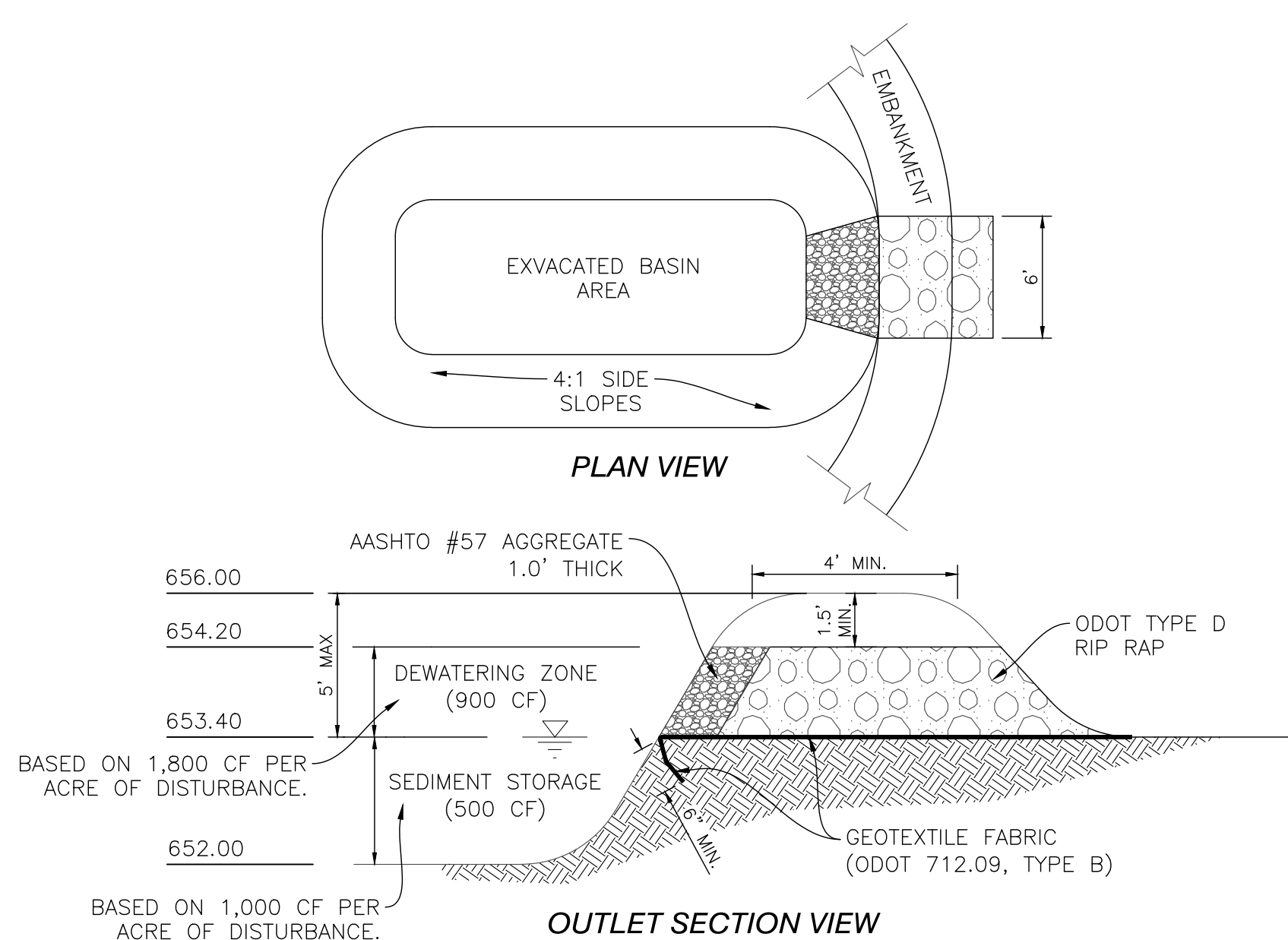

SEDIMENT TRAP
NOT TO SCALE

SPECIFICATIONS:

- WORK SHALL CONSIST OF THE INSTALLATION, MAINTENANCE, AND REMOVAL OF ALL SEDIMENT TRAPS AT THE LOCATIONS DESIGNATED ON THE DRAWINGS.
- SEDIMENT TRAPS SHALL BE CONSTRUCTED TO THE DIMENSIONS SPECIFIED ON THE DRAWINGS AND OPERATIONAL PRIOR TO UPSLOPE LAND DISTURBANCE.
- THE AREA BENEATH THE EMBANKMENT SHALL BE CLEARED, GRUBBED, AND STRIPPED OF VEGETATION TO A MINIMUM DEPTH OF SIX INCHES. THE POOL SHALL BE CLEARED AS NEEDED TO FACILITATE SEDIMENT CLEANOUT.
- FILL USED FOR THE EMBANKMENT SHALL BE EVALUATED TO ASSURE ITS SUITABILITY AND IT MUST BE FREE OF ROOTS OR OTHER WOODY VEGETATION, LARGE ROCKS, ORGANICS, OR OTHER OBJECTIONABLE MATERIALS. FILL MATERIAL SHALL BE PLACED IN SIX INCH LIFTS AND SHALL BE COMPACTED BY TRAVERSING WITH A SHEEPSFOOT OR OTHER APPROVED COMPACTION EQUIPMENT. FILL HEIGHT SHALL BE INCREASED FIVE PERCENT TO ALLOW FOR STRUCTURE/FOUNDATION SETTLEMENT. CONSTRUCTION SHALL NOT BE PERMITTED IF EITHER THE EARTHFILL OR COMPACTION SURFACE IS FROZEN.
- THE MAXIMUM HEIGHT OF EMBANKMENT SHALL BE FIVE FEET. ALL CUT AND FILL SLOPES SHALL BE 2:1 (H:V) OF FLATTER.
- A MINIMUM STORAGE VOLUME BELOW THE CREST OF THE OUTLET OF 67 CY FOR EVERY ACRE OF CONTRIBUTING DRAINAGE AREA SHALL BE ACHIEVED AT EACH LOCATION NOTED ON THE DRAWINGS WITH ADDITIONAL SEDIMENT STORAGE VOLUME PROVIDED BELOW THIS ELEVATION.
- TEMPORARY SEEDING SHALL BE ESTABLISHED AND MAINTAINED OVER THE USEFUL LIFE OF THE PRACTICE.
- THE OUTLET FOR THE SEDIMENT TRAP STRUCTURE SHALL BE CONSTRUCTED TO THE DIMENSIONS SHOWN ON THE DRAWINGS.
- THE OUTLET SHALL BE CONSTRUCTED USING THE MATERIALS SPECIFIED ON THE DRAWINGS. WHERE GEOTEXTILE IS USED, ALL OVERLAPS SHALL BE A MINIMUM OF TWO FEET OR AS SPECIFIED BY THE MANUFACTURER, WHICHEVER IS GREATER. ALL OVERLAPS SHALL BE MADE WITH THE UPPER MOST LAYER PLACED LAST. GEOTEXTILE SHALL BE KEPT IN AT LEAST SIX INCHES ON THE UPSLOPE SIDE OF THE OUTLET.
- WARNING SIGNS AND SAFETY FENCE SHALL BE PLACED AROUND THE TRAPS AND MAINTAINED OVER THE LIFE OF THE PRACTICE.
- AFTER ALL SEDIMENT-PRODUCING AREAS HAVE BEEN PERMANENTLY STABILIZED, THE STRUCTURE AND ALL ASSOCIATED SEDIMENT SHALL BE REMOVED. STABLE EARTH MATERIALS SHALL BE PLACED IN THE SEDIMENT TRAP AREA AND COMPACTED. THE AREA SHALL BE GRADED TO BLEND IN WITH ADJOINING LAND SURFACES AND HAVE POSITIVE DRAINAGE. THE AREA SHALL BE IMMEDIATELY SEEDED.



Know what's below.
Call before you dig.



JCKL ARCHITECTS

P.O. BOX 340037
COLUMBUS, OHIO 43234
PHONE: (614) 764-1996
tom@marsharchitects.com

NOT FOR CONSTRUCTION

EROSION/SEDIMENT CONTROL NOTES & DETAILS

BUCKEYE HILLS CAREER CENTER

NEW TRADES BUILDING

351 BUCKEYE HILLS ROAD
RIO GRANDE, OHIO 45674



PRELIMINARY 04-21-2022

BID SET 03-13-2024

PERMIT SET

REVISIONS:

03-13-2024
Bid Set

C4.0



DEMOLITION KEYNOTES

1. ASPHALT TO BE REMOVED AND REPLACED. REMOVE TO DEPTH AS NEEDED FOR PROPOSED GRADING. EXISTING STORM UNDERDRAINS SHALL BE LEFT IN PLACE.
2. NEATLY SAWCUT EDGE TO PROVIDE CLEAN STRAIGHT JOINT. APPLY ITEM 407, TACK COAT, TO EXPOSED VERTICAL FACE PRIOR TO PLACEMENT OF NEW PAVEMENT & SEAL JOINT WITH ITEM 705.04, HOT APPLIED JOINT SEALER. ASPHALT PAVEMENT TO BE REMOVED.
3. EXISTING BUILDING TO BE REMOVED

MISC. NOTES

- ALL ITEMS NOTED FOR DEMOLITION SHALL BE REMOVED & DISPOSED OF IN ACCORDANCE WITH ALL APPLICABLE FEDERAL & LOCAL REGULATIONS, UNLESS OTHERWISE DIRECTED BY THE OWNER.
- THE REMOVAL OF ANY ITEMS WHICH HAVE IN-GROUND FOUNDATIONS, BASES OR FOOTERS OF ANY KIND SHALL INCLUDE COMPLETE REMOVAL OF SAID FOUNDATIONS.
- UTILITIES MARKED "*" ARE DRAWN PER PLAN OR ARE IN AN ASSUMED LOCATION. SANDS DECKER ASSUMES NO LIABILITY FOR SAID UTILITY LOCATIONS.

SURVEYOR'S NOTE

THE EXISTING SURVEY INFORMATION SHOWN HEREON WAS PREPARED BY EXLINE SURVEYING, INC. ON 02/08/2022. SANDS DECKER CPS, LLC ASSUMES NO LIABILITY FOR ANY ERRORS OR OMISSIONS THEREIN.

BASIS OF BEARINGS (FROM EXLINE)

NORTH IS ORIENTED TO THE OHIO STATE PLANE COORDINATE SYSTEM, SOUTH ZONE, 1983.

ELEVATIONS WERE BASED ON NAVD 1988 DATUM ACQUIRED FROM OHIO DOT VRS NETWORK.

LEGEND

	P/L	PROPERTY LINE
	EASEMENT LINE	EASEMENT LINE
	UGE	UNDERGROUND ELECTRIC LINE
	OHEC	OVERHEAD ELECTRIC LINE
	UGT	UNDERGROUND TELEPHONE LINE
	W	WATER LINE
	FIRE	FIRE WATER LINE
	STM	STORM LINE
	UD	UNDER DRAIN
	SAN	SANITARY SEWER
	G	GAS LINE
	E/G	EDGE OF GRAVEL
	FENCE	FENCE
	CATCH BASIN	CATCH BASIN
	MANHOLE	MANHOLE
	DOWNSPOUT	DOWNSPOUT
	CLEANOUT	CLEANOUT
	WATER VALVE	WATER VALVE
	FIRE HYDRANT	FIRE HYDRANT
	GAS VALVE	GAS VALVE
	FIBER OPTIC MARKER	FIBER OPTIC MARKER
	COMMUNICATIONS PEDESTAL	COMMUNICATIONS PEDESTAL
	LIGHT POLE	LIGHT POLE
	TELEPHONE POLE	TELEPHONE POLE
	HVAC UNIT	HVAC UNIT
	ELECTRIC METER	ELECTRIC METER
	PULL BOX	PULL BOX
	DECIDUOUS TREE	DECIDUOUS TREE
	BOLLARD	BOLLARD
	POST	POST
	SIGN	SIGN
	PARKING BLOCK W/ COUNT	PARKING BLOCK W/ COUNT
	FINISHED FLOOR	FINISHED FLOOR
	BENCHMARK	BENCHMARK
	ASPHALT REMOVED	ASPHALT REMOVED
	BUILDING	BUILDING

ABBREVIATIONS

MH	MANHOLE
CB	CATCH BASIN
TC	TOP OF CASTING
FFL	FINISHED FLOOR
CNA	CANNOT ACCESS
TBM	TEMPORARY BENCHMARK

NORTH

GRAPHIC SCALE

0 10 20
1" = 20'

811
Know what's below.
Call before you dig.

SANDS DECKER
ENGINEERS & SURVEYORS

JCKL ARCHITECTS

P.O. BOX 340037
COLUMBUS, OHIO 43234
PHONE: (614) 764-1996
tom@marsharchitects.com

NOT FOR CONSTRUCTION

SITE DEMOLITION PLAN

BUCKEYE HILLS CAREER CENTER

NEW TRADES BUILDING

351 BUCKEYE HILLS ROAD
RIO GRANDE, OHIO 45674

PRELIMINARY 04-21-2022

BID SET 03-13-2024

PERMIT SET

REVISIONS:

03-13-2024
Bid Set

C5.0



- ### SITE KEYNOTES
- PAVEMENT MARKINGS INCLUDING PARKING SPACES, TRANSVERSE LINES, & ADA SYMBOLS PER ITEMS 641 & 642, TYP.
 - ADA PARKING SIGNAGE, TYP. SEE DETAIL.
 - PRECAST CONCRETE WHEEL STOP, INSTALLED & SECURED PER MANUFACTURER'S RECOMMENDATIONS, TYP., SEE DETAIL.
 - CONCRETE SIDEWALK, SEE DETAIL.
 - TBD
 - CONCRETE PAVEMENT, SEE DETAIL.
 - ONE 7" RISE STEP, SEE SHEET 8 FOR GRADING DETAILS.
 - 1.25" DOMESTIC WATER SERVICE LINE. COORDINATE BUILDING CONNECTION W/ MEP PLANS. TIE INTO EXISTING WATER LINE WITH TAPPING SLEEVE AND VALVE. CONTRACTOR SHALL CONFIRM SIZE OF EXISTING WATERLINE.
 - ROOF DRAIN CLEANOUT, TYP. SEE DETAIL.
 - 6" SANITARY SERVICE LINE @ 2.08% MIN. COORDINATE BUILDING CONNECTION & OIL INTERCEPTOR W/ MEP PLANS. CONTRACTOR SHALL VERIFY DEPTHS OF CROSSING UTILITIES PRIOR TO CONSTRUCTION, AND CONFLICTS SHALL BE REPORTED TO A/E UPON DISCOVERY. CONTRACTOR SHALL RAISE OR LOWER CROSSING UTILITIES IF IN CONFLICT. COORDINATE ALL WORK WITH UTILITY OWNER.
 - 8" ROOF DRAIN COLLECTORS @ 1.0% MIN. COORDINATE DOWNSPOUT CONNECTION W/ ARCHITECTURAL PLANS. OUTLET ROOF DRAIN INTO DETENTION BASIN AS SHOWN.
 - DRAINAGE SWALE, SEE GRADING PLAN.
 - OUTLET CONTROL STRUCTURE, SEE DETAIL.
 - OVERFLOW WEIR, SEE DETAIL.
 - 18" DEPTH, ROCK CHANNEL PROTECTION, TYPE C, W/ FILTER.

- ### MISC. NOTES
- SEE ARCHITECTURAL, MECHANICAL, STRUCTURAL, & ELECTRICAL PLANS FOR ADDITIONAL DETAILS.
 - CONTRACTOR SHALL VERIFY ALL DIMENSIONS ON THE GROUND & REPORT ANY LAYOUT DISCREPANCIES IMMEDIATELY TO THE A/E.
 - UTILITIES MARKED "M" ARE DRAWN PER PLAN OR ARE IN AN ASSUMED LOCATION. SANDS DECKER TAKES NO LIABILITY FOR SAID UTILITY LOCATIONS.
 - CAUTION IS TO BE USED WHEN MILLING/EXCAVATING TO AVOID CONFLICT WITH UNDERGROUND UTILITIES. CONTRACTOR TO EXCAVATE AREA TO LOCATE UTILITY PRIOR TO CONSTRUCTION.
 - SEE ARCH. PLANS FOR BOLLARD LOCATIONS & DETAIL.

LEGEND

- ①** STORM STRUCTURE LABEL (SEE PROFILE)
- Ⓐ** SANITARY STRUCTURE LABEL (SEE PROFILE)
- CONCRETE. SEE KEYNOTES & DETAILS.
- STANDARD DUTY ASPHALT PAVEMENT. SEE DETAILS.

JCKL ARCHITECTS
 P.O. BOX 340037
 COLUMBUS, OHIO 43234
 PHONE: (614) 764-1996
 tom@marsharchitects.com

NOT FOR CONSTRUCTION

BUCKEYE HILLS CAREER CENTER
BUCKEYE HILLS CAREER CENTER

SITE DIMENSION PLAN
BUCKEYE HILLS CAREER CENTER
NEW TRADES BUILDING
 351 BUCKEYE HILLS ROAD
 RIO GRANDE, OHIO 45674

- PRELIMINARY 04-21-2022
- BID SET 03-13-2024
- PERMIT SET
- REVISIONS:

03-13-2024
 Bid Set

811
 Know what's below.
 Call before you dig.

NORTH

GRAPHIC SCALE
 1" = 20'

SANDS DECKER
 ENGINEERS & SURVEYORS

C6.0



1 GRADING KEYNOTES

1. INLET PROTECTION (TYP.), SEE DETAIL.
2. SEDIMENT FENCE (TYP.), SEE DETAIL.
3. PROPOSED DETENTION BASIN SHALL BE USED AT A TEMPORARY SEDIMENT TRAP DURING CONSTRUCTION, SEE DETAIL.
4. DITCH CHECK (TYP.), SEE DETAIL.
5. SEE SHEET 8 FOR BLOW-UP GRADING DETAIL OF SIDEWALK/PAVEMENT AREA.

MISC. NOTES

- CONTRACTOR SHALL PROVIDE A CONCRETE WASHOUT AREA PER DETAIL. LOCATION SHALL BE DETERMINED IN THE FIELD.
- GRADE BOXES HAVE BEEN TRUNCATED FOR LEGIBILITY. ADD 600 TO ALL SPOT ELEVATIONS.
- FOR SWP3 NOTES & DETAILS, SEE SHEET C4.
- UTILITIES MARKED "*" ARE DRAWN PER PLAN OR ARE IN AN ASSUMED LOCATION. SANDS DECKER TAKES NO LIABILITY FOR SAID UTILITY LOCATIONS.
- CAUTION IS TO BE USED WHEN MILLING/EXCAVATING TO AVOID CONFLICT WITH UNDERGROUND UTILITIES. CONTRACTOR TO EXCAVATE AREA TO LOCATE UTILITY PRIOR TO CONSTRUCTION.
- ALL SLOPES EQUAL TO OR STEEPER THAN 3:1 SHALL BE STABILIZED USING TEMPORARY EROSION CONTROL MATTING INSTALLED AND SECURED ACCORDING TO MANUFACTURER'S RECOMMENDATIONS.
- THE CONTRACTOR SHALL NOT ALLOW DIRECT DISCHARGE OF SEDIMENT LADEN WATER TO A SEWER SYSTEM OR A RECEIVING STREAM OR POND.

LEGEND

- 1000— EXISTING CONTOUR
- 970— PROPOSED CONTOUR
- (1) STORM STRUCTURE NUMBER
- ➔ MAJOR STORM ROUTING
- 91.30 SPOT ELEVATION
- X91.54 EXISTING ELEVATION
- ☐ INLET PROTECTION (TYP.)
- ▭ SEDIMENT FENCE (TYP.)
- ▨ DITCH CHECK (TYP.)

JCKL ARCHITECTS
 P.O. BOX 340037
 COLUMBUS, OHIO 43234
 PHONE: (614) 764-1996
 tom@marsharchitects.com

NOT FOR CONSTRUCTION

GRADING & EROSION/SEDIMENT CONTROL PLAN
BUCKEYE HILLS CAREER CENTER
NEW TRADES BUILDING
 351 BUCKEYE HILLS ROAD
 RIO GRANDE, OHIO 45674



☐ PRELIMINARY 04-21-2022
 ■ BID SET 03-13-2024
 ☐ PERMIT SET
 ☐ REVISIONS:

03-13-2024
 Bid Set

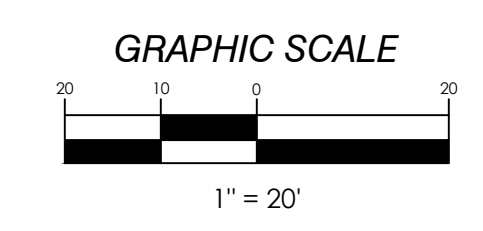
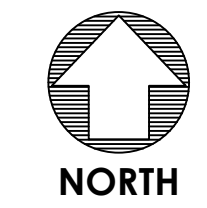
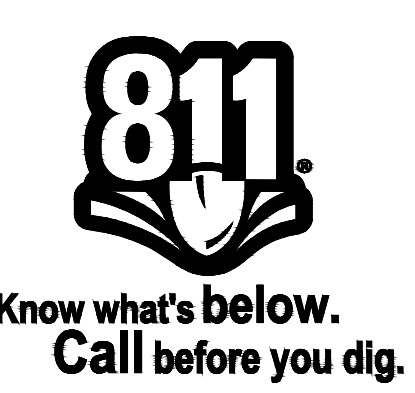

C7.0

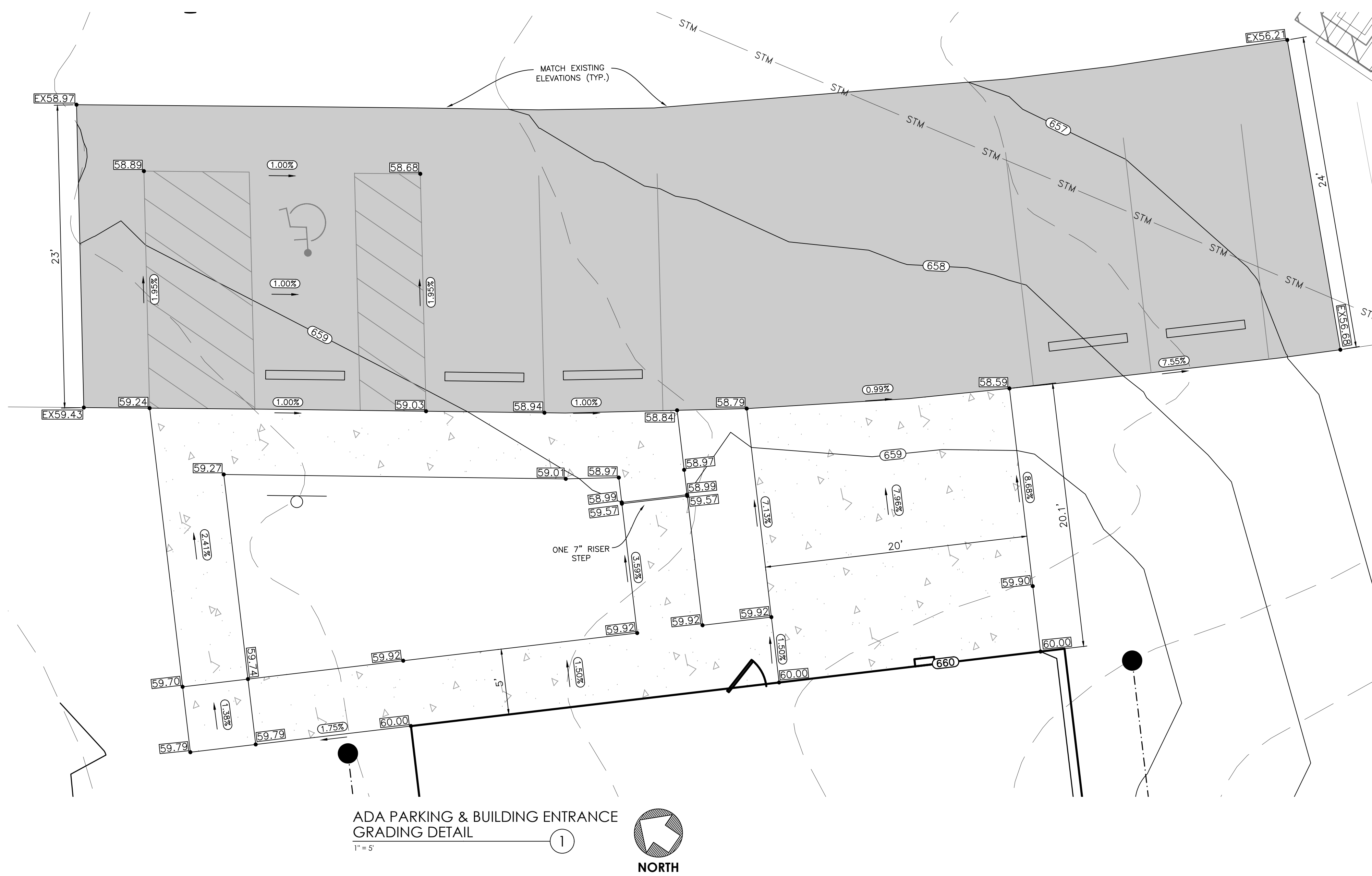

ADA PARKING & BUILDING ENTRANCE GRADING DETAIL
1"=5'

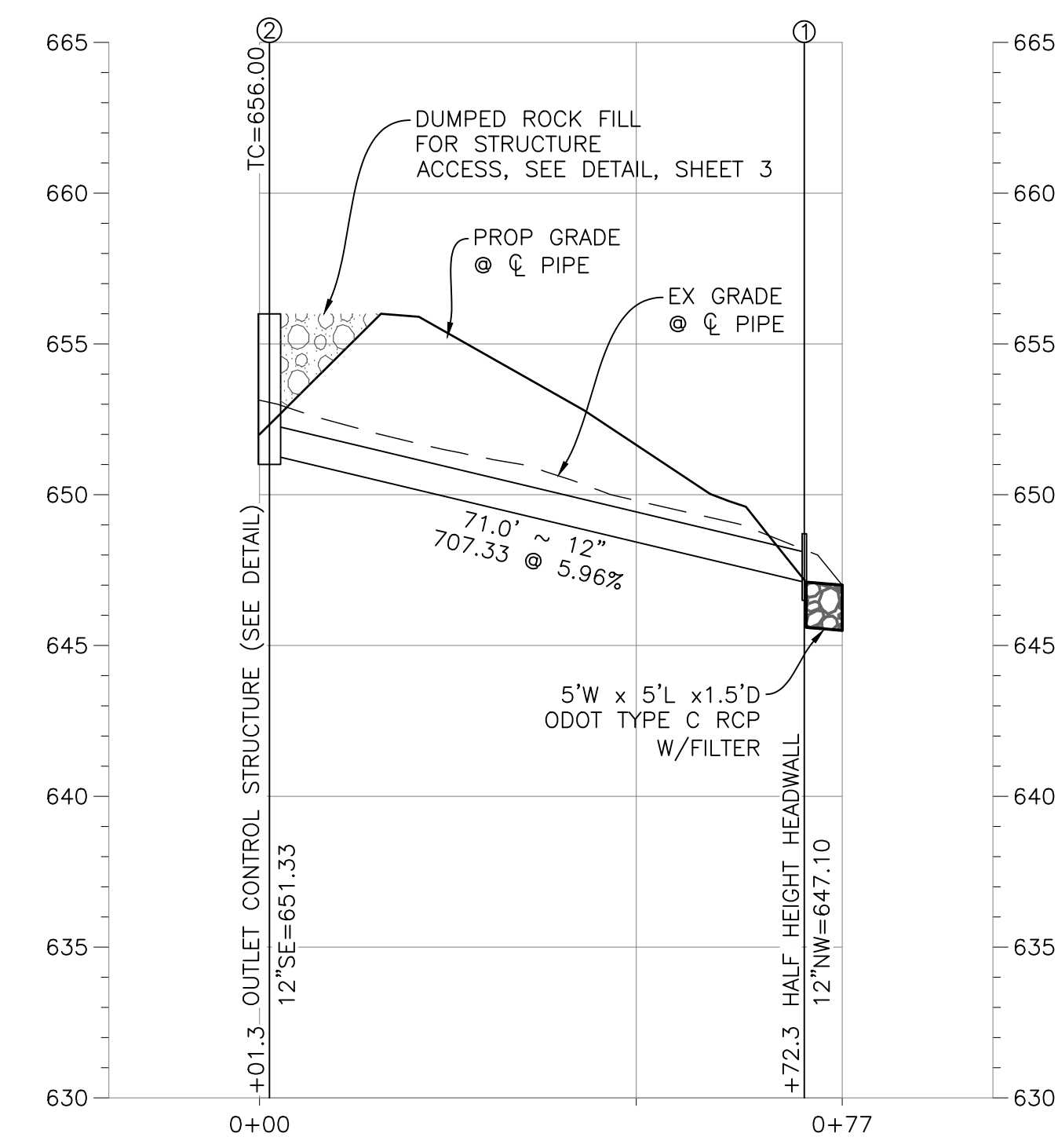

STORM SEWER PROFILE STRUCTURES 1-2
V=1:5 H=1:20

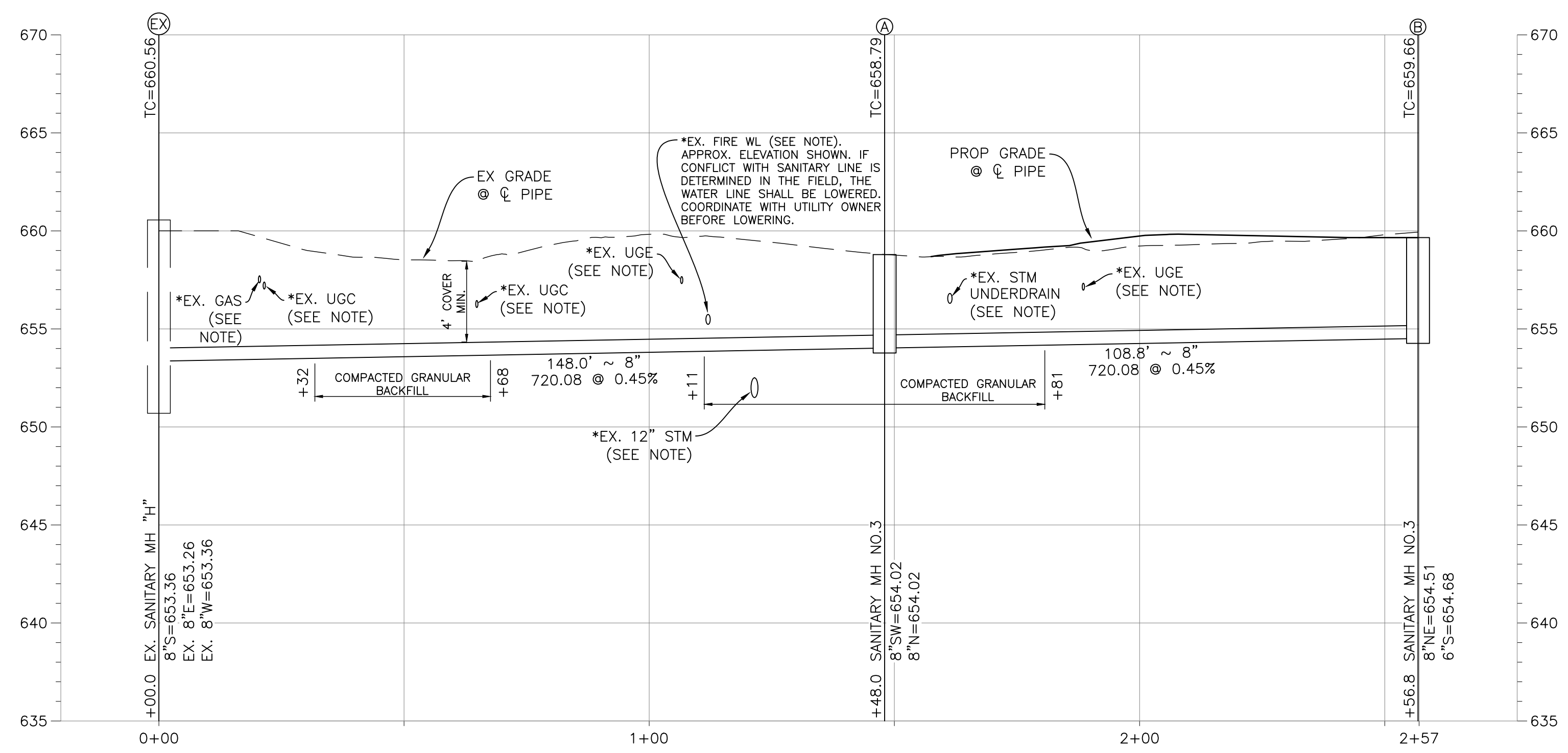

8" SANITARY SEWER PROFILE STRUCTURES EX "H" --> B
V=1:5 H=1:20

NOTES:
 - *SIZES AND ELEVATIONS OF EXISTING CROSSING PIPES SHOWN ON THE PROFILES ARE APPROXIMATE BASED ON SURVEYED INVERTS AND CALCULATED SLOPES. CONTRACTOR SHALL VERIFY EXISTING PIPE ELEVATIONS AND SIZES BEFORE PROCUREMENT OF ANY SEWER MATERIALS (STRUCTURES, PIPING, ETC.). IF THE CONTRACTOR'S FINDINGS CREATE A CONFLICT WITH THE PROPOSED PLANS, THEN THE CONTRACTOR SHALL IMMEDIATELY INFORM THE ARCHITECT/ENGINEER OF THE CONFLICT.

NOT FOR CONSTRUCTION

GRADING DETAIL & SEWER PROFILES
 BUCKEYE HILLS CAREER CENTER
 NEW TRADES BUILDING
 351 BUCKEYE HILLS ROAD
 RIO GRANDE, OHIO 45674

- PRELIMINARY 04-21-2022
- BID SET 03-13-2024
- PERMIT SET
- REVISIONS:

03-13-2024
 Bid Set

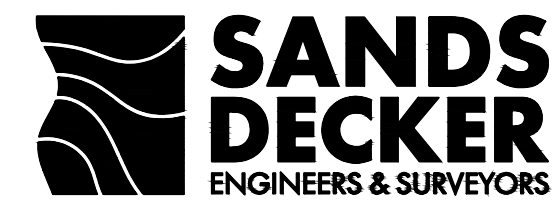

C8.0